

EAST GOSHEN MUNICIPAL AUTHORITY

July, 09, 2012

Monday 7:00 PM

1. CALL TO ORDER/PLEDGE OF ALLEGIANCE/MOMENT OF SILENCE
 - a. Ask if anyone will be taping the meeting?
2. CHAIRMAN'S REPORT/OTHER MEMBERS REPORTS
3. APPROVAL OF MINUTES
 - a. June 11, 2012
4. APPROVAL OF INVOICES

a. Penmoni #511381	\$ 2,125.00
b. Penmoni #511382	\$ 707.25
c. Penmoni #511383	\$ 1,142.00
d. Penmoni #511384	\$ 7,009.25
e. Penmoni #511385	\$ 3,050.25
f. Gawthrop Greenwood #99747	\$ 570.00
g. Mallie, Falconiero & Co. #1000016943	\$ 7,900.00
h. Chester County Conservation - Reserve	\$ 250.00
i. Chester County Conservation – HM PS	\$ 250.00
j. Xylem Godwin #400230917	\$ 4,780.00
k. Power Pro Equipment #P42685	\$ 450.00
l. Lenni Electric #120640	\$ 352.68
5. LIAISON REPORTS
6. FINANCIAL REPORTS
 - a. June 2012 Report
 - b. Memo on Lochwood plant Closing labor Costs
7. OLD BUSINESS
 - a. Project update for Marydell, Reserve and Hershey Mill sewer deversions
8. GOALS
 - a. June Goals
9. NEW BUSINESS
 - a. Consider Resolution 31
10. CAPACITY REQUESTS
 - a. Goshen Meadows Cond. Use Application
11. SEWER REPORTS
 - a. Director of Public Works Report
 - b. Penmoni Engineer's Report

- d. Big Fish Environmental Inc Report with DMR's
- e. East Goshen Township Flows for June 2012

- 12. ANY OTHER MATTER
- 13. CORRESPONDENCE AND REPORTS OF INTEREST
- 14. PUBLIC COMMENT
- 15. ADJOURNMENT

Meetings & Dates of Importance

July 09, 2012	Municipal Authority	7:00 PM
July 11, 2012	Planning Commission	9-12:00PM
July 11, 2012	Conservancy Board	7:00 PM
July 12, 2012	Historical Com.	7:00PM
July 12, 2012	Farmers Market	3-7:00PM
July 16, 2012	Commerce Dev. Comm.	7:00 PM
July 17, 2012	Board of Supervisors	7:00 PM
	CU App.	
	Goshen Meadows	
July 30 – Aug. 4, 2012	Goshen Country Fair	
	Station 54 Fairgrounds	

Reminder – NEWSLETTER ARTICLE SUBMISSION DUE DATES:

<u>Article Due Date</u>	<u>Website Posting Date</u>
Aug 1, 2012	Oct. 1, 2012

draft
EAST GOSHEN TOWNSHIP MUNICIPAL AUTHORITY
MEETING MINUTES
June 11, 2012

The East Goshen Township Municipal Authority held their regularly scheduled meeting on Monday, June 11, 2012 at 7:00pm at the East Goshen Township building. Members in attendance were: Vice Chairman Fran Beck, Joe McCawley, Jack Yahraes, and Kevin Cummings. Also in attendance were: Rick Smith (Township Manager), Mark Miller (Director of Public Works), Jon Altshul (Township CFO), Walter Wujick (Conservancy Board), and Dan Barbato (Pennoni).

Call to Order & Pledge of Allegiance

Fran called the meeting to order at 7:00pm and led those present in the Pledge of Allegiance. There was a moment of silence to remember the troops. Fran asked if anyone would be recording the meeting and there was no response.

Chairman's Report/Other Members' Reports

1. Joe was not able to attend the West Goshen Municipal Authority meeting in May.
2. Community Day on Saturday June 23, 2012 was discussed. It was decided that a poster will be provided describing what the Municipal Authority does.

Approval of Minutes

The Chairman noted that the minutes of the May 14, 2012 meeting were approved as corrected.

Approval of Invoices

Joe moved to approve payment of the following Pennoni invoices:

a. Pennoni #501145	\$ 920.25
b. Pennoni #507185	\$ 498.50
c. Pennoni #507186	\$ 320.50
d. Pennoni #507187	\$ 289.75
e. Pennoni #507188	\$ 6,049.00
f. Pennoni #507189	\$ 558.00

Jack seconded the motion. There was no further discussion. The motion passed unanimously.

Joe moved to approve payment of the SMJ Construction Payment #1 Lockwood Div. for \$105,473.97. Jack seconded the motion. Kevin liked the format they used for the billing. There was no further discussion. The motion passed unanimously.

Liaison Reports

1. Conservancy Board – Walter reported that the Board worked with Mark Miller to identify invasives along East Boot Road which the Public Works Department removed. In the Fall, the Board will start planting this area. On their agenda for this month's meeting is discussion about the proposal to build a house at 1410 Linden Lane.

2. Historical Commission – Ellen asked Jack to report that Living History Day on Saturday, June 2, 2012 was a huge success. The estimate that there was 550 – 600 guests and there were 50 people helping.

Financial Reports – Jon Altshul, CFO, announced that he invited an auditor who will come to the July meeting. Jon reviewed the May 21st letter from the auditors. The \$5,000 limit given to Rick and Mark for emergencies, was discussed. Kevin feels there should be something more than a mention in the minutes about this. Rick will check and, if there is no resolution, he will prepare one.

Jon reviewed his memo which outlined basic internal financial controls. Fran and the members thanked Jon for his report. They agree with his recommendations. Rick and Kevin will work on an outline about how the Municipal Authority does business.

Jon mentioned the required Statement of Financial Interest that each board member has to complete every year. The members all stated that they turned one in for this year.

Old Business

1. Clinger Invoice – Rick had the revised Clinger invoice #M11143-R for \$1,228.08 which reflects the journeyman's hourly rate of \$102.3. Jack moved to approve payment. Kevin seconded the motion. The motion passed unanimously.

Goals

1. Newsletter – Dana will do an article for Fall.
2. Jack suggested putting new items in BOLD.

New Business

1. Hershey's Mill Pump Station Grinder – Pennoni's proposal was reviewed. Mark mentioned that, with Lockwood closed, the debris has doubled and the trash rack must be cleaned daily. The Muffin Monster will take care of this. They will purchase the Muffin Monster from the manufacturer JWC Environmental. They will also sign up for the service program which supplies a replacement machine while the other is being repaired so there is no down time. The total cost will be \$74,000. Joe moved to approve the proposal and purchase the Muffin Monster. Fran seconded the motion. The motion passed unanimously.

2. Meter Quote from Allied Control Services – Mark explained the purpose of the Flo-Dar Sensor. The cost will be \$15,460. Jack moved to approve the purchase of the Flo-Dar Sensor. Joe seconded the motion. The motion passed unanimously.

Capacity Requests

None.

Sewer Reports

a. Mark Miller, Director of Public Works Report:

Meters: Were read on a daily basis, adjustments were made to Ellis Lane.

Chester Creek Collection: We replaced all the manhole castings in Marydell a total of (44); while replacing the castings each manhole was checked for infiltration. We televised and cleaned the Ashbridge Farms development; we located one leaky lateral which was repaired on June 5. The crew found a broken tee and a cracked clean-out.

1 The crew also televised the drop manhole in Hershey Mill; the one the contractor tied
2 into for the Lockwood project. The drop was ok. We pulled pump number one, a total of
3 8150 feet were televised and cleaned.

4 Ridley Creek Collection: We also televised pipe along Paoli Pike where we located
5 two breaks; rather than digging we will be installing a slip liner. We also found a leaking
6 lateral which we already repaired.

7 Lockwood Project: The contractor is currently doing restoration work installing curb,
8 raking and seeding. The plant operator is spraying on a daily basis. I located a contractor
9 who needs to get rid of 5000 yards of fill dirt; his job should start in about 3 weeks. Matt
10 from Pennoni still has to air test and vacuum test the lines. The contractor also has to
11 grout the old lines. That work is scheduled for one day next week.

12 Ridley Creek: In your packet is the quote for the new flow meter from Allied Control;
13 the meter is being supplied from HACH who is on COSTARS for state pricing. I would
14 recommend going with the meter Allied quoted. Also in your packet is the cost for the
15 new sampler.

16 PA 1 Calls: We responded to 88 PA 1 calls for the month of May.

17 Alarms: We responded to 23 alarms in May that ranged from power outages to pump
18 failure.

19 Mark also reported that the request for Plant Operator is out and several companies were
20 shown the facility.

21
22 b. **Pennoni Engineer's Report** - Dan Barbato provided the following report:

23 Invoices - With summaries were provided under separate cover.

24 Ridley Creek Sewage Treatment Plant –

25 • No activity this period. We will assist with supporting and reviewing
26 warranty claims and with plant troubleshooting as requested.

27 LCSTP Elimination

28 • The contractor, SJM Construction Company, has completed construction
29 of all new sewers and manholes. All effected residences have had their laterals tied into
30 the new sewers, and the entire Lockwood Chase neighborhood now flows through the
31 new sewers. All but two new sewer runs have been pressure tested and passed. The
32 remaining two runs are planned for pressure testing by Friday, June 8.

33 • Remaining work generally includes final restoration, abandoning existing
34 sewers and manholes in-place with flowable fill, paving, curb replacement, installation of
35 cast-iron boxes and lids on cleanouts, manhole vacuum testing, mandrel testing and
36 televising of new sewers, and preparation of as-built plans. We anticipate the majority of
37 this work will be completed by Friday, June 15. The required contract completion date is
38 July 2, 2012.

39 • We have performed on-site, part-time construction inspection services
40 throughout the duration of this work. We have also provided in-office construction to
41 resolve utility conflicts and other unforeseen issues.

42 • We reviewed Invoice #1 and forwarded our recommendation to the
43 township.

44 Hershey Mill PS Diversion, Reserve PS Elimination Planning

45 • As reported previously, we have prepared draft plans and draft
46 applications for DEP General Permits (GP) for Stream Crossings. The PNDI Receipt for

1 the Hershey's Mill PS Diversion identified potential threats to endangered plant species.
2 We prepared and submitted the required documents to DCNR for their
3 comments/approval regarding the potential threats. DCNR responded that a qualified
4 botanist must perform an on-site evaluation of a variety of plants commonly found in
5 serpentine soils. We provided additional information and coordinated with DCNR to
6 resolve their concerns without involving a botanist. They have since rescinded the
7 requirement for further investigation, and they issued a letter stating that no impacts are
8 anticipated. We are also coordinating with the Township to determine how to tie into the
9 existing downstream manhole for the Reserve Pump Station diversion because there are
10 elevation conflicts with the depth of sewer across the creek and tying into the existing
11 manhole. We expect to resolve these conflicts and submit both the Reserve PS and the
12 Hershey's Mill PS General Permit application to DEP the week of June 11/15.

13 Marydell PS Elimination Planning

14 • As reported previously, we have prepared draft plans and a draft PennDOT
15 Highway Occupancy Permit (HOP) application. We are continuing attempts to
16 coordinate with PECO regarding mitigation of impacts to overhead utility poles given the
17 proximity of the proposed sewer to the poles. The PECO coordination may impact the
18 HOP application, such as modifications to the exact sewer location. Upon resolution of
19 any such PECO issues, we will finalize and submit the HOP application. We have also
20 submitted the draft plans to Verizon, and we have requested information from them on
21 the exact location of their conduits in Paoli Pike because it may be less problematic to
22 install the sewer under the edge of pavement (as opposed to the currently designed route
23 on the shopping center side of the PECO utility poles) pending PECO comments and to
24 avoid significant tree disturbance along the shopping center frontage.

25 Hershey's Mill PD Capacity Evaluation

26 • We performed drawdown testing at the pump station and an analysis of pump and
27 system curves to verify the station has capacity to handle peak instantaneous flows
28 following the Lockwood Chase diversion. One pump was found to have inadequate
29 capacity. The township quickly replaced the pump. We will perform a follow-up
30 drawdown test on Monday, June 11, to confirm the replaced pump has adequate capacity.

31 Hershey's Mill Grinder

32 • We performed a site visit to evaluate the potential for installation of a comminutor
33 (grinder) in the pump station to replace the existing trash rack. We prepared a budgetary
34 cost estimate for the work which we forwarded to the Township along with a professional
35 services proposal to prepare construction drawings and a bid package.

36 Chapter 94 Reports

37 • PA DEP responded to the Ridley Creek Chapter 94 Report submission. One
38 comment notes that documentation should be provided to show that the pump station can
39 convey maximum flows with any one pump out of service. This documentation was not
40 required for the current submittal and DEP noted on their letter that no additional
41 information is required to be submitted at this time. This analysis will be provided in the
42 2013 submission.

43
44 **c. Big Fish Environmental Services, Inc.** Scott Towler submitted the following report
45 on plant operations for May 2012:

1 Treatment Process Operation – Sequencing batch reactors (SBRs) numbered 1, 3 and 4
2 were in service during the month of May. SBR #2 remains out of service with the
3 majority of the contents transferred to the aerobic sludge holding tanks.

4 It is regrettable to report permit exceedances for total suspended solids and total
5 phosphorus during the month of April. Split samples between the contract laboratory and
6 the in-house laboratory were analyzed. Observations of the final effluent appeared to
7 have no visible solids readily identifiable as mixed liquor solids carryover, however, the
8 in-house suspended solids test appeared to indicate a measureable concentration of
9 colloidal solids. Total phosphorus is related to the suspended solids concentration,
10 therefore, as the suspended solids concentration increases, the total phosphorus
11 concentration is anticipated to increase. Steps were implemented with the laboratory to
12 improve access to laboratory reports, specifically with phosphorus results. In addition,
13 continued split sampling and comparison of the in-house test results and contract
14 laboratory results is on-going. Preliminary data for the month of May anticipates full
15 compliance with the discharge permit. A summary of the influent and effluent sample
16 data for the month of March 2012 is attached for review. The eDMR and supplemental
17 reports for April 2012 have been prepared and submitted PA DEP by BFESI through the
18 electronic cDMR system.

19 Solids Dewatering and Disposal

20 The centrifuge was placed in service for 4 days during April. Two dumpsters were
21 removed from the site during April. The centrifuge remained out of service during the
22 month of May 2012.

23 Alarm/Emergency Responses

24 During the month of May, continued alarms were received for the failure of CV-34 to
25 open. This item is currently being address by Worth & Co as a warranty item. May 16,
26 2012 all 3 Watson Marlow pumps failed as the result of over current. The pumps were
27 reset and returned to service. May 20, 2012 SBR #3 effluent valve failed to close
28 resulting in the loss of 4.71 feet (60,594 gallons) of the SBR contents (MLSS) into the
29 post EQ tanks. The actuator valve was adjusted and the valve returned to function as
30 designed. May 21, 2012 alum tank alarm for high level was activated. The alarm was
31 reset and cleared.

32 Maintenance, Repairs and Warranty

33 Outstanding: Centrifuge replacement parts – Worth & Co to replace parts used for
34 warranty repair

35 Outstanding: JWC fine screen has a failed UPS – Worth & Co informed

36 Completed: JWC fine screen upstream transducer – replacement connection scheduled
37 for installation

38 Outstanding: SBR and Centrifuge MCC panel hour meters – Worth & Co informed

39 Completed: Leaking PVC valves for alum piping to SBRs

40 Outstanding: Sludge holding tank aeration piping paint is failing.

41
42 Any Other Matter - None

43
44 Correspondence and Reports of Interest - None

45
46 Public Comment – None

1
2 **Adjournment**

3 There being no further business, Joe moved to adjourn the meeting. Kevin seconded the motion.
4 The motion passed unanimously. The meeting was adjourned at 8:30pm.
5

6 Respectfully submitted,
7

8
9 Ruth Kiefer

10 Recording Secretary



INVOICE

Newark, DE
302-655-4451 Fax: 302-654-2895

Remit Payment To:
Pennoni Associates Inc.
P.O. Box 827328
Philadelphia, PA 19182-7328

East Goshen Municipal Authority
1580 Paoli Pike
West Chester, PA 19380-6199
Attention: Louis F. Smith, Twp Mgr.

Invoice # : 511381
Invoice Date : 06/28/2012
Project : EGMA1107
Project Name : Hershey Mill & Reserve PS Div Des
Per

For Services Rendered through: 06/17/2012

Alternatives analysis and design for Reserve PS stream crossing, manhole connection, and bench modification. On-site meeting with client to review options. Response to DCNR concern for Serpentine impacts along Hershey Mill PS Diversion route. Preparation of DEP GP-5 applications for Reserve PS and Hershey Mill PS Diversions.

Phase : 1 -- Design

Total Phase : 1 -- Design

Labor :	971.25
Expense :	0.00
Phase Total :	971.25

Phase : 6 -- PADEP General Permits

Total Phase : 6 -- PADEP General Permits

Labor :	1,153.75
Expense :	0.00
Phase Total :	1,153.75

Amount Due This Invoice

\$2,125.00

Fee :	60,200.00
Prior Billings :	14,686.00
Current Billings :	2,125.00
Total Billings :	16,811.00

PS 7/6/12

Continued on next page...

INVOICES DUE ON RECEIPT. Invoices outstanding over 30 days will have a Service Charge of 1 1/2% per month.

...Continued from previous page

Phase : 1 -- Design

Labor Class	<i>Hours/ Units</i>	<i>Rate</i>	<i>Amount</i>
Authority Engineer	0.75	110.00	82.50
Project Engineer	8.75	93.00	813.75
Technical Specialist	1.00	75.00	75.00
Labor Total:	10.50		971.25

Total Phase : 1 -- Design**Labor : \$971.25****Expense : \$0.00****Phase : 6 -- PADEP General Permits**

Labor Class	<i>Hours/ Units</i>	<i>Rate</i>	<i>Amount</i>
Project Engineer	6.75	93.00	627.75
Associate Engineer	5.75	83.00	477.25
Engineering Technician I	0.75	65.00	48.75
Labor Total:	13.25		1,153.75

Total Phase : 6 -- PADEP General Permits**Labor : \$1,153.75****Expense : \$0.00****Total Project : EGMA1107 -- HersheyMill & Reserve PS Div Des Per****Labor : \$2,125.00****Expense : \$0.00**

INVOICES DUE ON RECEIPT. Invoices outstanding over 30 days will have a Service Charge of 1 1/2% per month.

East Goshen Municipal Authority
EGMA1107 Invoice Summary

Project: EGMA1107
Pennoni Job No.: Hershey Mill & Reserve PS Div Des Per
Invoice No: 511381
Invoice Period: 5/14/2012 to 6/17/2012
Initial Authorization: \$ 60,200.00 **Date:** 7/7/2011
Contract Amount: \$ 60,200.00
Previously Invoiced: \$ 14,686.00
Current Invoice: \$ 2,125.00
Invoiced to Date (\$): \$ 16,811.00
Invoiced to Date (%): 28%
Remaining Budget (\$): \$ 43,389.00
Remaining Budget (%): 72%

Budget by Phase:
Phase No. *****
Phase Name: Hershey Mill & Reserve
Phase Budget: \$ 60,200.00
Previously Invoiced: \$ 14,686.00
Current Invoice: \$ 2,125.00
Invoiced to Date (\$): \$ 16,811.00
Invoiced to Date (%): 28%
Remaining Budget (\$): \$ 43,389.00
Remaining Budget (%): 72%

Comments: Alternatives analysis and design for Reserve PS stream crossing, manhole connection, and bench modification. On-site meeting with client to review options.
Response to DCNR concern for Serpentine impacts along Hershey Mill PS Diversion route.
Preparation of DEP GP-5 applications for Reserve PS and Hershey Mill PS Diversions.



INVOICE
Newark, DE
302-655-4451 Fax: 302-654-2895

Remit Payment To:
Pennoni Associates Inc.
P.O. Box 827328
Philadelphia, PA 19182-7328

East Goshen Municipal Authority
1580 Paoli Pike
West Chester, PA 19380-6199
Attention: Louis F. Smith, Twp Mgr.

Invoice # : 511382
Invoice Date : 06/28/2012
Project : EGMA1109
Project Name : Marydell Pump Station Diversion

For Services Rendered through: 06/17/2012

Field meeting with client to discuss sewer location along Paoli Pike and utility conflicts. Correspondence with PECO and Verizon regarding utility conflicts and existing conditions.

Phase : 1 -- Design

Total Phase : 1 -- Design

Labor : 707.25
Expense : 0.00
Phase Total : 707.25

Amount Due This Invoice

\$707.25

Fee : 45,100.00
Prior Billings : 5,816.75
Current Billings : 707.25
Total Billings : 6,524.00

Phase : 1 -- Design

Labor Class	Hours/ Units	Rate	Amount
Project Engineer	2.25	93.00	209.25
Associate Engineer	6.00	83.00	498.00
Labor Total:	8.25		707.25

Total Phase : 1 -- Design

Labor : \$707.25
Expense : \$0.00

Total Project : EGMA1109 -- Marydell Pump Station Diversion

Labor : \$707.25
Expense : \$0.00

RS 7/6/12

East Goshen Municipal Authority
EGMA1109 Invoice Summary

Project: EGMA1109
Pennoni Job No.: Marydell Pump Station Diversion
Invoice No: 511382
Invoice Period: 5/14/2012 to 6/17/2012
Initial Authorization: \$ 45,100.00 **Date:** 2/22/2012
Contract Amount: \$ 45,100.00
Previously Invoiced: \$ 5,816.75
Current Invoice: \$ 707.25
Invoiced to Date (\$): \$ 6,524.00
Invoiced to Date (%): 14%
Remaining Budget (\$): \$ 38,576.00
Remaining Budget (%): 86%

Budget by Phase:
Phase No. *****
Phase Name: Marydell Pump
Station Diversion
Phase Budget: \$ 45,100.00
Previously Invoiced: \$ 5,816.75
Current Invoice: \$ 707.25
Invoiced to Date (\$): \$ 6,524.00
Invoiced to Date (%): 14%
Remaining Budget (\$): \$ 38,576.00
Remaining Budget (%): 86%

Comments: Field meeting with client to discuss sewer location along Paoli Pike and utility conflicts. Correspondence with PECO and Verizon regarding utility conflicts and existing conditions.



INVOICE

Newark, DE
302-655-4451 Fax: 302-654-2895

Remit Payment To:
Pennoni Associates Inc.
P.O. Box 827328
Philadelphia, PA 19182-7328

East Goshen Municipal Authority
1580 Paoli Pike
West Chester, PA 19380-6199
Attention: Louis F. Smith, Twp Mgr.

Invoice # : 511383
Invoice Date : 06/28/2012
Project : EGMA1201
Project Name : 2012 General Services

For Services Rendered through: 06/17/2012

Mike Ellis attendance at May MA meeting. Engineer's report for May. FloDAR meter research. Review packet and attend June MA meeting.

Phase : **** -- Professional Services

Total Phase : **** -- Professional Services

Labor :	1,142.00
Expense :	0.00
Phase Total :	1,142.00

Amount Due This Invoice

\$1,142.00

Fee :	10,000.00
Prior Billings :	1,774.75
Current Billings :	1,142.00
Total Billings :	2,916.75

Phase : **** -- Professional Services

Labor Class	Hours/ Units	Rate	Amount
Authority Engineer	7.00	110.00	770.00
Project Engineer	4.00	93.00	372.00
Labor Total:	11.00		1,142.00

Total Phase : **** -- Professional Services

Labor :	\$1,142.00
Expense :	\$0.00

Total Project : EGMA1201 -- 2012 General Services

Labor :	\$1,142.00
Expense :	\$0.00

RS 7/6/12

East Goshen Municipal Authority
EGMA1201 Invoice Summary

Project: EGMA1201
Pennoni Job No.: 2012 General Services
Invoice No: 511383
Invoice Period: 5/14/2012 to 6/17/2012
Initial Authorization: \$ 10,000.00 **Date:** 2/22/2012
Contract Amount: \$ 10,000.00
Previously Invoiced: \$ 1,774.75
Current Invoice: \$ 1,142.00
Invoiced to Date (\$): \$ 2,916.75
Invoiced to Date (%): 29%
Remaining Budget (\$): \$ 7,083.25
Remaining Budget (%): 71%

Budget by Phase:

Phase No.	****
	2012 General
Phase Name:	Services
Phase Budget:	\$ 10,000.00
Previously Invoiced:	\$ 1,150.80
Current Invoice:	\$ 1,142.00
Invoiced to Date (\$):	\$ 2,292.80
Invoiced to Date (%):	23%
Remaining Budget (\$):	\$ 7,707.20
Remaining Budget (%):	77%

Comments: Mike Ellis attendance at May MA meeting. Engineer's report for May.
FloDAR meter research. Review packet and attend June MA meeting.



INVOICE

Newark, DE
302-655-4451 Fax: 302-654-2895

Remit Payment To:
Pennoni Associates Inc.
P.O. Box 827328
Philadelphia, PA 19182-7328

East Goshen Municipal Authority
1580 Paoli Pike
West Chester, PA 19380-6199
Attention: Louis F. Smith, Twp Mgr.

Invoice #: 511384
Invoice Date: 06/28/2012
Project: EGMA1204
Project Name: Lockwood Chase Construction
Phase S

For Services Rendered through: 06/17/2012

Review and markup of contractor payment request #1. Field meeting to discuss pond dewatering at plant. On-site inspection and observation of construction as requested by the Authority. Coordination and management of project activities and inspections.

Phase : **** -- Professional Services

Total Phase : **** -- Professional Services

Labor : 7,009.25
Expense : 0.00
Phase Total : 7,009.25

Amount Due This Invoice

\$7,009.25

Fee : 19,000.00
Prior Billings : 10,004.50
Current Billings : 7,009.25
Total Billings : 17,013.75

Phase : **** -- Professional Services

Labor

Class	Hours/ Units	Rate	Amount
Project Engineer	13.50	93.00	1,255.50
Technical Specialist	76.50	75.00	5,737.50
Engineering Technician I	0.25	65.00	16.25
Labor Total:	90.25		7,009.25

Total Phase : **** -- Professional Services

Labor : \$7,009.25
Expense : \$0.00

Total Project : EGMA1204 -- Lockwood Chase Construction Phase S

Labor : \$7,009.25
Expense : \$0.00

RS 7/6/12

INVOICES DUE ON RECEIPT. Invoices outstanding over 30 days will have a Service Charge of 1 1/2% per month.

East Goshen Municipal Authority
EGMA1204 Invoice Summary

Project: EGMA1204
Pennoni Job No.: Lockwood Chase Construction Phase S
Invoice No: 511384
Invoice Period: 5/14/2012 to 6/17/2012
Initial Authorization: \$ 16,000.00 **Date:** 2/22/2012
Contract Amount: \$ 19,000.00
Previously Invoiced: \$ 10,004.50
Current Invoice: \$ 7,009.25
Invoiced to Date (\$): \$ 17,013.75
Invoiced to Date (%): 90%
Remaining Budget (\$): \$ 1,986.25
Remaining Budget (%): 10%

Budget by Phase:

Phase No.	*****
	Construction Phase
Phase Name:	S
Phase Budget:	\$ 19,000.00
Previously Invoiced:	\$ 10,004.50
Current Invoice:	\$ 7,009.25
Invoiced to Date (\$):	\$ 17,013.75
Invoiced to Date (%):	90%
Remaining Budget (\$):	\$ 1,986.25
Remaining Budget (%):	10%

Comments: Review and markup of contractor payment request #1. Field meeting to discuss pond dewatering at plant. On-site inspection and observation of construction as requested by the Authority.
Coordination and management of project activities and inspections.



INVOICE

Newark, DE
302-655-4451 Fax: 302-654-2895

Remit Payment To:
Pennoni Associates Inc.
P.O. Box 827328
Philadelphia, PA 19182-7328

East Goshen Municipal Authority
1580 Paoli Pike
West Chester, PA 19380-6199
Attention: Louis F. Smith, Twp Mgr.

Invoice # : 511385
Invoice Date : 06/28/2012
Project : EGMA1205
Project Name : Hershey Mill PS Comminutor Cost Est

For Services Rendered through: 06/17/2012

Pump station wetwell drawdown testing on two occasions, before and after replacement of Pump #1. Analysis of pumping capacity and recommendations. Correspondence with DEP regarding permit requirements for Muffin Monster. Determine location for Muffin Monster installation. Evaluate Muffin Monster power supply alternatives and locations with Mark Miller.

Phase : **** -- Professional Services

Total Phase : **** -- Professional Services

Labor :	3,050.25
Expense :	0.00
Phase Total :	3,050.25

Amount Due This Invoice

\$3,050.25

Fee :	4,000.00
Prior Billings :	558.00
Current Billings :	3,050.25
Total Billings :	3,608.25

Phase : **** -- Professional Services

Labor

Class	Hours/ Units	Rate	Amount
Project Engineer	26.75	93.00	2,487.75
Technical Specialist	7.50	75.00	562.50
Labor Total:	34.25		3,050.25

Total Phase : **** -- Professional Services

Labor :	\$3,050.25
Expense :	\$0.00

Total Project : EGMA1205 -- Hershey Mill PS Comminutor Cost Est

Labor :	\$3,050.25
Expense :	\$0.00

olc 725 7/6/12

INVOICES DUE ON RECEIPT. Invoices outstanding over 30 days will have a Service Charge of 1 1/2% per month.

East Goshen Municipal Authority
EGMA1205 Invoice Summary

Project: EGMA1205
Pennoni Job No.: Hershey Mill PS Comminutor Cost Est
Invoice No: 511385
Invoice Period: 5/14/2012 to 6/17/2012
Initial Authorization: \$ 4,000.00 **Date:** 5/15/2012
Contract Amount: \$ 4,000.00
Previously Invoiced: \$ 558.00
Current Invoice: \$ 3,050.25
Invoiced to Date (\$): \$ 3,608.25
Invoiced to Date (%): 90%
Remaining Budget (\$): \$ 391.75
Remaining Budget (%): 10%

Budget by Phase:

Phase No.	****
	PS Comminutor
Phase Name:	Cost Est
Phase Budget:	\$ 4,000.00
Previously Invoiced:	\$ 558.00
Current Invoice:	\$ 3,050.25
Invoiced to Date (\$):	\$ 3,608.25
Invoiced to Date (%):	90%
Remaining Budget (\$):	\$ 391.75
Remaining Budget (%):	10%

Comments: Pump station wetwell drawdown testing on two occasions, before and after replacement of Pump #1. Analysis of pumping capacity and recommendations. Correspondence with DEP regarding permit requirements for Muffin Monster. Determine location for Muffin Monster installation. Evaluate Muffin Monster power supply alternatives and locations with Mark Miller.



Gawthrop Greenwood, PC
Attorneys at Law

17 East Gay Street, Suite 100 | (p) 610-696-8225
West Chester, PA 19381-0562 | (f) 610-344-0922
gglaw@gawthrop.com | www.gawthrop.com

East Goshen Municipal Authority
1580 Paoli Pike
West Chester PA 19380

Page: 1
05/31/2012
Client No: 6604-01M
Invoice No. 99747

General Authority Services

Fees

		Hours		
05/14/2012	RFA	Review packet for Authority meeting of 5/14/12; attend regular meeting of Authority and tour of RCSTP.		
		3.00		
		3.00		570.00
		For Current Services Rendered		
		Recapitulation		
	<u>Timekeeper</u>	<u>Hours</u>	<u>Hourly Rate</u>	<u>Total</u>
	Robert F. Adams	3.00	\$190.00	\$570.00
	Previous Balance			\$703.00
	Total Current Charges			570.00
05/16/2012	Fee Payment			-703.00
	Balance Due			<u>\$570.00</u>

OK TJS 6/15

To ensure proper credit, please write client number on your check when returning payment. Thank You.
A finance charge of 1.25% per month (15% annually) may be charged on balances not paid 60 days after the invoice date.



MAILLIE, FALCONIERO & COMPANY, LLP

Certified Public Accountants and Business Counselors

■ P.O. Box 680

■ Oaks, PA 19456-0680

Phone: (610) 935-1420

E-mail: firm@maillie.com

Web: www.maillie.com

Client Number: 2500
East Goshen Municipal Authority
Attn: Mr. Rick Smith
1580 Paoli Pike
West Chester, PA 19380-6107

Invoice: 1000016943

Date: 06/18/2012

Due Date: 07/18/2012

For examination of the financial statements of the Authority for the year ended December 31, 2011 and assistance with preparation of Management Discussion and Analysis report

\$7,900.00

Billed Time & Expenses

\$7,900.00

Invoice Total

\$7,900.00

APPROVED BY: RS
DATE PAID: _____
CHECK #: _____
CHARGED TO: 07424,3110

<u>06/18/2012</u>	<u>05/31/2012</u>	<u>04/30/2012</u>	<u>03/31/2012</u>	<u>02/29/2012+</u>	<u>Total</u>
7,900.00	0.00	0.00	0.00	0.00	\$7,900.00

Please return this portion with payment.

Invoice: 1000016943

ID: 2500
East Goshen Municipal Authority
(610)692-7171

Date: 06/18/2012

Due Date: 07/18/2012

Amount Due: \$7,900.00

Amount Enclosed: \$ _____

Finance charges of 1 1/2% per month will be added to the unpaid balance of accounts over 30 days from invoice date. Annual percentage rate of 18%.

Chester County Conservation District
688 Unionville Road, Suite 200, Kennett Square, PA 19348
(610) 925-4920 ~ Fax: (610) 925-4925 ~ www.chesco.org/conservation
APPLICATION FOR DISTRICT SERVICES – Revised 06.01.12

- Application will not be accepted unless signed and completed in its entirety.
- Please update the information on this form with each submission.
- Only folded plans will be accepted.

E&SPC Submission: ☒ New ☐ 1st Revision ☐ 2nd Revision ☐ 3rd Revision ☐ 4th Revision *Note -Additional Fee Due
NPDES Submission: ☐ New ☐ Revision ☐ *Renewal ☐ *Major Amendment *Note- Additional Fee Due

Project Name: Hershey Mill Pump Station Diversion Date: July 5, 2012
Project Site Location: 970 to 972 Cornwallis Drive Municipality: East Goshen Township Tax Parcel ID: Multiple
Project Acres: 0.62 acres Total Cumulative Acres Disturbed Over Project Life: <0.62 acres
Development Type: ☐ Residential: _____ # of Units ☐ Industrial/Commercial/Institutional/Townhouses/Condominiums
☐ Timber Harvest ☒ Municipal
☐ Miscellaneous: ☐ Small Agricultural ☐ Large Agricultural ☒ Chapter 105 ☐ Pond/Stream Work
Other Info: Linear construction - sewer force main installation via horizontal directional drilling
Applicant (Owner/Firm): East Goshen Municipal Authority Name: Rick Smith, Township Manager
Applicant Mailing Address: 1580 Paoli Pike Email: rsmith@eastgoshen.org
City: West Chester State: PA Zip Code: 19380 Phone: 610-692-7171 Fax: 610-692-8950
Plan Designer (Firm): Pennoni Associates Inc. Name: Michael Ellis, PE
Plan Designer Mailing Address: 121 Continental Drive, Suite 207 Email: mellis@pennoni.com
City: Newark State: DE Zip Code: 19713 Phone: 302-655-4451 Fax: 302-654-2895

E&SPC Fees: Base Fee: \$ 250.00 Tier II Fee: \$ N/A Emergency Review Fee: \$ N/A
E&SPC fees are payable to Chester County Conservation District - Submit two checks: one check for Base Fee and Tier II, if applicable, and one check for Emergency Review, if applicable.

Refer to District Services Fee Schedule, and check appropriate Tier II:
☐ 9% or more slopes ☐ deficient infiltration of 2 year storm ☐ more than 25% total area disturbance
☐ less than 100 foot buffer ☐ adjacent property discharge

NPDES Fees: Base Fee: \$ N/A Disturbed Acreage Fee: \$ N/A
Base Fee is payable to Chester County Conservation District Clean Water Fund
Disturbed Acreage Fee is payable to Commonwealth of PA Clean Water Fund

Complete the following:

Receiving Stream Name: <u>Ridley Creek</u>	Designation (HQ, EV, etc): <u>HQ-TSF, MF</u>
Fee Attached <input checked="" type="checkbox"/>	Act 2 Site (requires Individual NPDES Permit) <input type="checkbox"/>
Stormwater Narrative <input type="checkbox"/>	Emergency Prep. Plan <input type="checkbox"/>
Stormwater Management <input type="checkbox"/>	E&S Narrative <input checked="" type="checkbox"/>
Post Construction Stormwater Plans <input type="checkbox"/>	E&S Calculations <input type="checkbox"/>
& Details <input type="checkbox"/>	E&S Plans & Details <input checked="" type="checkbox"/>

Incentive BMPs: ☐ Green Roof ☐ Community Redevelopment
☐ Use of Spent Mushroom Compost as a soil amendment, for stabilization, and/or wetland creation

Plan Information – Check if the project contains any of the following:

Stream Crossing <input checked="" type="checkbox"/>	Public Sewer <input checked="" type="checkbox"/>
Wetlands <input type="checkbox"/>	On Site Septic <input type="checkbox"/>
Flood Plain <input type="checkbox"/>	Steep Slopes <input type="checkbox"/>
Water Encroachment <input type="checkbox"/>	Open Space <input type="checkbox"/>

Permits Required – Enclose copies if applicable:

NPDES Individual Permit <input type="checkbox"/>	General Permit (Chapter 105) <input checked="" type="checkbox"/>
NPDES General Permit <input type="checkbox"/>	Water Encroachment <input type="checkbox"/>
	Joint Permit 401/404 <input type="checkbox"/>

Fees and plans showing the required information are to be submitted with this application. Any additional plans or information required by the Chester County Conservation District should be submitted promptly. Emergency plan reviews require an additional request form that can be found on our website. There is a 25% review fee reduction incentive for Best Management Practices. The request for this reduction must be submitted in writing and attached with this submission. Please see our website for more information. The undersigned agrees to comply with all of the requirements of TITLE 25, CHAPTER 102, EROSION AND SEDIMENTATION CONTROL RULES AND REGULATIONS as set forth by the Pennsylvania Department of Environmental Protection, and further agrees to obtain all necessary permits in connection with the above referenced project. District Service Fees are non-refundable.

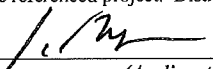
 Ty MCIL
(Applicant Signature)

CHECK REQUEST FORM

Date form submitted:

6-28-12

Date & time check needed:

7-5-12

Approved:

Rick

Date Paid:

Check #:

Charged to:

07426-1000

Pay to the order of:

CHESTER COUNTY CONSERVATION DISTRICT

Mailing Address:

Amount of check:

250⁰⁰

Special Instructions:
(check one)

☐ Mail check: regular mail.

☐ Mail check: express mail.

☒ Return check to requester.

☐ Hold check until: _____.

Explanation of Expenses:
(attach invoice, slips, etc.)

PERMIT FEE
HM PS PROTECT

Request submitted by:

Rick

Rick Smith

From: Ellis, Michael <MEllis@Pennoni.com>
Sent: Wednesday, June 27, 2012 5:04 PM
To: rsmith@eastgoshen.org
Subject: CCCD permit fees, Paoli Pk utilities

Hi Rick,

We expect to make E&S plan submissions to the Conservation District next week for the Hershey Mill and Reserve diversions. Even though we're less than 1 ac disturbance on each, we have to get their E&S approval as part of the General Permit for stream crossings. I expect to make both submissions to them next week. The District's application fee is \$250.00 for Chapter 105 (General Permit) projects. There is no reduced fee for municipal authorities. Can the Township/Authority provide two \$250.00 checks as part of these submissions next week?

On a separate subject, we found out today from the utility locator that the red mark-out along the edge of Paoli Pike is a gas anode line. We will reach out to PECO's gas division to get more info on it. I do not expect that it will prevent us from putting the sewer there, but we may need to slightly relocate the anode line as part of the project. Verizon informed us that they own the ductbank along Paoli Pike. AT&T has cables inside Verizon's ductbank there. The ductbank is apparently NOT encased in concrete. They're going to send us plans and details of the ductbank.

Mike

Michael J. Ellis, PE

Pennoni Associates Inc.
Christiana Executive Campus
121 Continental Drive, Suite 207
Newark, DE 19713-4310
Office 302-655-4451 x5236 | Direct 302-351-5236
Fax 302-654-2895 | Mobile 302-561-4235
<http://www.pennoni.com> | mellis@pennoni.com

Consulting Engineers providing...

*Environmental – Geotechnical – Inspection & Testing – Land Development – MEP
Landscape Architecture – Structural – Survey – Transportation – Water/Wastewater*

2 CHECKS

Chester County Conservation District
688 Unionville Road, Suite 200, Kennett Square, PA 19348
(610) 925-4920 ~ Fax: (610) 925-4925 ~ www.chesco.org/conservation
APPLICATION FOR DISTRICT SERVICES – Revised 06.01.12

- Application will not be accepted unless signed and completed in its entirety.
- Please update the information on this form with each submission.
- Only folded plans will be accepted.

E&SPC Submission: ☒ New ☐ 1st Revision ☐ *2nd Revision ☐ *3rd Revision ☐ *4th Revision *Note - Additional Fee Due
NPDES Submission: ☐ New ☐ Revision ☐ *Renewal ☐ *Major Amendment *Note - Additional Fee Due

Project Name: Reserve Pump Station Diversion Date: July 5, 2012
Project Site Location: Vicinity of 929 Forest Lane Municipality: East Goshen Township Tax Parcel ID: Multiple
Project Acres: 0.45 acres Total Cumulative Acres Disturbed Over Project Life: 0.45 acres
Development Type: ☐ Residential: # of Units ☐ Industrial/Commercial/Institutional/Townhouses/Condominiums
☐ Timber Harvest ☒ Municipal
☐ Miscellaneous: ☐ Small Agricultural ☐ Large Agricultural ☒ Chapter 105 ☐ Pond/Stream Work
Other Info: Linear construction - gravity sewer installation with open cut stream crossing
Applicant (Owner/Firm): East Goshen Municipal Authority Name: Rick Smith, Township Manager
Applicant Mailing Address: 1580 Paoli Pike Email: rsmith@eastgoshen.org
City: West Chester State: PA Zip Code: 19380 Phone: 610-692-7171 Fax: 610-692-8950
Plan Designer (Firm): Pennoni Associates Inc. Name: Michael Ellis, PE
Plan Designer Mailing Address: 121 Continental Drive, Suite 207 Email: mellis@pennoni.com
City: Newark State: DE Zip Code: 19713 Phone: 302-655-4451 Fax: 302-654-2895

E&SPC Fees: Base Fee: \$ 250.00 Tier II Fee: \$ N/A Emergency Review Fee: \$ N/A
E&SPC fees are payable to Chester County Conservation District - Submit two checks: one check for Base Fee and Tier II, if applicable, and one check for Emergency Review, if applicable.

Refer to District Services Fee Schedule, and check appropriate Tier II:
☐ 9% or more slopes ☐ deficient infiltration of 2 year storm ☐ more than 25% total area disturbance
☐ less than 100 foot buffer ☐ adjacent property discharge

NPDES Fees: Base Fee: \$ N/A Disturbed Acreage Fee: \$ N/A
Base Fee is payable to Chester County Conservation District Clean Water Fund
Disturbed Acreage Fee is payable to Commonwealth of PA Clean Water Fund

Complete the following:

Receiving Stream Name: <u>Ridley Creek</u>	Designation (HQ, EV, etc): <u>HQ-TSF, MF</u>
Fee Attached <input checked="" type="checkbox"/>	Act 2 Site (requires Individual NPDES Permit) <input type="checkbox"/>
Stormwater Narrative <input type="checkbox"/>	Emergency Prep. Plan <input type="checkbox"/>
Stormwater Management <input type="checkbox"/>	E&S Narrative <input checked="" type="checkbox"/>
Post Construction Stormwater Plans <input type="checkbox"/>	E&S Calculations <input type="checkbox"/>
& Details <input type="checkbox"/>	E&S Plans & Details <input checked="" type="checkbox"/>

Incentive BMPs: ☐ Green Roof ☐ Community Redevelopment
☐ Use of Spent Mushroom Compost as a soil amendment, for stabilization, and/or wetland creation

Plan Information – Check if the project contains any of the following:

Stream Crossing <input checked="" type="checkbox"/>	Public Sewer <input checked="" type="checkbox"/>
Wetlands <input checked="" type="checkbox"/>	On Site Septic <input type="checkbox"/>
Flood Plain <input type="checkbox"/>	Steep Slopes <input type="checkbox"/>
Water Encroachment <input type="checkbox"/>	Open Space <input type="checkbox"/>

Permits Required – Enclose copies if applicable:

NPDES Individual Permit <input type="checkbox"/>	General Permit (Chapter 105) <input checked="" type="checkbox"/>
NPDES General Permit <input type="checkbox"/>	Water Encroachment <input type="checkbox"/>
	Joint Permit 401/404 <input type="checkbox"/>

Fees and plans showing the required information are to be submitted with this application. Any additional plans or information required by the Chester County Conservation District should be submitted promptly. Emergency plan reviews require an additional request form that can be found on our website. There is a 25% review fee reduction incentive for Best Management Practices. The request for this reduction must be submitted in writing and attached with this submission. Please see our website for more information. The undersigned agrees to comply with all of the requirements of TITLE 25, CHAPTER 102, EROSION AND SEDIMENTATION CONTROL RULES AND REGULATIONS as set forth by the Pennsylvania Department of Environmental Protection, and further agrees to obtain all necessary permits in connection with the above referenced project. District Service Fees are non-refundable.

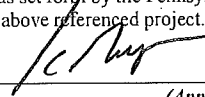
(Applicant Signature)

CHECK REQUEST FORM

Date form submitted: 6-28-12

Date & time check needed: 7-5-12

Approved: TCS

Date Paid: _____

Check #: _____

Charged to: ~~07426-10~~
07427-1000

Pay to the order of: CHESTER COUNTY CONSERVATION DISTRICT

Mailing Address: _____

Amount of check: 250⁰⁰

Special Instructions:
(check one)

☐ Mail check: regular mail.

☐ Mail check: express mail.

☒ Return check to requester.

☐ Hold check until: _____.

Explanation of Expenses:
(attach invoice, slips, etc.)

PERMIT FEE
RESERVE P S PROJECT

Request submitted by: Tuck

Rick Smith

From: Ellis, Michael <MEllis@Pennoni.com>
Sent: Wednesday, June 27, 2012 5:04 PM
To: rsmith@eastgoshen.org
Subject: CCCD permit fees, Paoli Pk utilities

Hi Rick,

We expect to make E&S plan submissions to the Conservation District next week for the Hershey Mill and Reserve diversions. Even though we're less than 1 ac disturbance on each, we have to get their E&S approval as part of the General Permit for stream crossings. I expect to make both submissions to them next week. The District's application fee is \$250.00 for Chapter 105 (General Permit) projects. There is no reduced fee for municipal authorities. Can the Township/Authority provide two \$250.00 checks as part of these submissions next week?

On a separate subject, we found out today from the utility locator that the red mark-out along the edge of Paoli Pike is a gas anode line. We will reach out to PECO's gas division to get more info on it. I do not expect that it will prevent us from putting the sewer there, but we may need to slightly relocate the anode line as part of the project. Verizon informed us that they own the ductbank along Paoli Pike. AT&T has cables inside Verizon's ductbank there. The ductbank is apparently NOT encased in concrete. They're going to send us plans and details of the ductbank.

Mike

Michael J. Ellis, PE

Pennoni Associates Inc.
Christiana Executive Campus
121 Continental Drive, Suite 207
Newark, DE 19713-4310
Office 302-655-4451 x5236 | Direct 302-351-5236
Fax 302-654-2895 | Mobile 302-561-4235
<http://www.pennoni.com> | mellis@pennoni.com

Consulting Engineers providing...

*Environmental – Geotechnical – Inspection & Testing – Land Development – MEP
Landscape Architecture – Structural – Survey – Transportation – Water/Wastewater*

2 CHECKS



Let's Solve Water



Sold by:

Invoice

Branch 001

84 Floodgate Road
Bridgeport, NJ 08014-0191
Tel: 856-467-3636
Fax: 856-467-3636

Remit to:

P.O. Box 935152
Atlanta, GA 31193-5152
Phone: 856-467-3636

APPROVED BY:

DATE PAID: 07/24/2012

CHECK #: 051233702

CHARGED TO: 051233702

S
H
I
P
T
O

East Goshen Township
1580 Paoli Pike
West Chester PA 19380-6107

S
O
L
D
T
O

East Goshen Township
1580 Paoli Pike
West Chester, PA 19380-6107

Page 1 of 2

Customer PO	Ordered By	Contract Date	Date Shipped	Sale Contract #	Sales Representative		Order Taken By	Payment Terms
Lockwood Chase	Mr. Mark Miller	06-07-2012	06-11-2012	201031186	Daniel R. Pulcher		Mark Griffith	Net 30
ITEM	DESCRIPTION			QTY ORDERED	QTY SHIPPED	QTY B/O'd	SELL PRICE	EXTENDED SELL
ESDW0025VA000	Godwin Sub-Prime GSP25-HV Submersible Pump <ul style="list-style-type: none">• 3" Male NPT Discharge• 2.5 HP Electric Motor• 230 Volt, 1 phase S/N: 0850101 E-Code: 82802716			1	1	0	2,800.00	2,800.00
CPCA1P0122900	Godwin Auto Control Panel <ul style="list-style-type: none">• Maximum Overload 12 Amps• 1 Phase S/N: BZ-400089 E-Code: 18948			1	1	0	1,080.00	1,080.00
CAPTNA016	N/O' Mechanical Pilot Float Switch <ul style="list-style-type: none">• 65' Cord Length			2	2	0	0.00	0.00
AD030030CFPFA0	3" Female Cam & Groove x 3" Female NPT Adapter			1	1	0	0.00	0.00
HSDS030050CGD	3" x 50' Heavy Duty Layflat Hose with Cam & Groove Fittings			3	3	0	300.00	900.00

ALL PAST DUE INVOICES ARE SUBJECT TO
1 1/2% PER MONTH SERVICE CHARGE

\$4780



godwin®

Invoice

Branch 001
84 Floodgate Road
Bridgeport, NJ 08014-0191
Tel: 856-467-3636
Fax: 856-467-4841

Remit to: Xylem Dewatering Solutions, Inc.
P.O. Box 935152
Atlanta, GA 31193-5152
Phone: 856-467-3636

Sold by:

SO LD TO

East Goshen Township
1580 Paoli Pike
West Chester PA 19380-6107

SH - D HO

East Goshen Township
1580 Paoli Pike
West Chester, PA 19380-6107

Cust. No.	Invoice Date	Invoice No.
00005093	06-11-2012	400230917

Page 2 of 2

Customer PO	Ordered By	Contract Date	Date Shipped	Sale Contract #	Sales Representative	Order Taken By	Payment Terms						
Lockwood Chase	Mr. Mark Miller	06-07-2012	06-11-2012	201031186	Daniel R. Pulcher	Mark Griffith	Net 30						
ITEM	DESCRIPTION			QTY ORDERED	QTY SHIPPED	QTY B/O'd	SELL PRICE	EXTENDED SELL					
DZONE02PICKUP	Delivery Zone 2 - Pickup Truck			1	1	0	0.00	0.00					
ALL PAST DUE INVOICES ARE SUBJECT TO 1 1/2% PER MONTH SERVICE CHARGE				Merchandise		Labor		Shipping		Misc. Charges		Taxes	
				\$ 4,780.00		\$ 0.00		\$ 0.00		\$ 0.00		\$ 0.00	
Total Invoice							\$ 4,780.00						



☐ NEW HOLLAND, PA 17557
(717) 354-4241

☐ WEST CHESTER, PA 19380
(610) 738-9000

☐ ALLENTOWN, PA 18106
(610) 395-6499

33043

REMIT TO:
POWER PRO EQUIPMENT
780 EAST MAIN STREET
NEW HOLLAND, PA 17557

Customer
080067

I N V O I C E

Invoice
P42685

Pg
1

APPROVED BY: MB

DATE PAID: _____

6/21/12

CHECK #: _____

Sold To

CHARGED TO: 07424-7477

Ship To

EAST GOSHEN TOWNSHIP
1580 PAOLI PIKE
WEST CHESTER PA 19380

EAST GOSHEN TOWNSHIP
1580 PAOLI PIKE
WEST CHESTER PA 19380

610/692-7171

610/692-7171

Br	Trk	Make	Model	Serial	Equipment	Meter	Sls	Customer P.O.
002							57	LOCKWOOD SEWER

Ordr	Ship	B/O	Description	Each	Amount
	Taken By	KS		Shipped	6/21/12
50	50		CS 74102003	9.00	450.00
			TOTAL PARTS		450.00
			NON TAX - GOVT		.00
			NT-GOVT		

--< THANK YOU FOR YOUR BUSINESS >--
WWW.POWERPROEQUIPMENT.COM

Total 450.00

TERMS: A 1 1/2% PER MONTH LATE CHARGE IS ADDED TO THE UNPAID BALANCE ON ACCOUNTS PAST DUE PER TERMS REFERENCED ABOVE. THIS IS AN 18% ANNUAL PERCENTAGE RATE. PAST DUE ACCOUNTS WILL BE REFERRED FOR COLLECTION AND CUSTOMER IS LIABLE FOR LEGAL COSTS. ALL CLAIMS AND RETURNED GOODS MUST BE ACCOMPANIED BY THIS INVOICE. THERE IS A 15% RESTOCKING CHARGE AFTER SEVEN (7) DAYS. STORAGE CHARGE 30 DAYS AFTER NOTIFICATION.

We accept all major credit cards





33008
APPROVED BY: MAN
DATE PAID: _____
CHECK #: _____
CHARGED TO: 07924-7477

Service Invoice

Invoice#: 120640

Date: 06/20/2012

Billed To: East Goshen Township
1580 Paoli Pike
West Chester PA 19380

Project: 31253
LOCKWOOD STATION
923 DOLPHIN DR
WEST CHESTER PA 19380

Scheduled: 06/18/2012
Time:

Employee:

Order#:

Description	UM	Quantity	Price	Ext Price
LOCKWOOD - TEMP PUMP JUNE 18, 2012 SET UP TEMPORARY TO PUMP CONTROLLER TO DRAIN LAGOONS; ENERGIZE AND TEST; DEMO DISCONNECT & CONTROLLER FOR COMMUNUTOR, PLACE IN BUILDING				
ELECTRICIAN - 2 MEN, 2 HRS EA	HR	4.00	69.00	276.00
SERVICE TRUCK	HR	2.00	20.00	40.00
70' 12-2 ROMEX, MISC HDWRE	LS	1.00	36.68	36.68

Notes:

Terms are Net 30 days.
Balances over 30 days are subject to a finance charge of 2% per month.
Thank you for your prompt payment!

Non-Taxable Amount:	352.68
Taxable Amount:	0.00
Sales Tax:	0.00
Amount Due	352.68

Memo

To: Municipal Authority
From: Jon Altshul
Re: July 2012 Financial Report
Date: July 6, 2012

Attached please find the June Financial Report for the Municipal Authority. Total expenses were \$129,812.67, compared with total revenue of \$102,016.71 (primarily due to a \$100,000 transfer from the sewer capital reserve fund), for a net change in fund balance of -\$27,795.96.

Note also that the beginning fund balance of \$107,480.84 is slightly higher by \$16.62 than the May ending fund balance, due to interest income that posted after the May report was prepared.

EAST GOSHEN TOWNSHIP
1580 PAOLI PIKE
WEST CHESTER, PA
Municipal Authority
June 2012

Account Title	Acct #	Annual Budget	Month To Date Actual	Year To Date Actual
---------------	--------	---------------	----------------------	---------------------

MUNICIPAL AUTHORITY BEGINNING FUND BALANCE

107,480.84 *See Below

RCSTP BUDGET

REVENUE

INTEREST EARNED - RCSTP EXPANSION	07341 1020	0.00	9.67	54.56
GRANT REVENUE	07392 0800	0.00	0.00	0.00
TOTAL REVENUE		0.00	9.67	54.56

EXPENSES

R.C.-CAP. PROJ.-ENGINEER	07424 7451	0.00	0.00	0.00
R.C. CAP EXPANSION GEN'L CONTRACTOR	07424 7452	0.00	0.00	0.00
R.C. CAP EXPANSION - ELECTRICAL	07424 7453	0.00	1,228.08	1,228.08
R.C. CAP EXP CONTINGENCY CAPITAL	07424 7454	0.00	0.00	0.00
R.C. CAP EXP CONTINGENCY ONGOING	07424 7455	0.00	0.00	0.00
R.C. CAP EXP ADDITIONAL CONTINGENCY	07424 7456	0.00	0.00	0.00
TRANSFER TO AUTHORITY CAP FUND	07492 0990	0.00	0.00	0.00
TOTAL EXPENSES		0.00	1,228.08	1,228.08

RCSTP NET RESULT

	0.00	(1,218.41)	(1,173.52)
--	------	------------	------------

OPERATING BUDGET

REVENUE

EAST GOSHEN TOWNSHIP
1580 PAOLI PIKE
WEST CHESTER, PA
Municipal Authority
June 2012

Account Title	Acct #	Annual Budget	Month To Date Actual	Year To Date Actual
INTEREST EARNINGS	07341 1000	0.00	7.04	20.37
C.C. TAPPING FEES	07364 1100	2,000.00	0.00	0.00
R.C. TAPPING FEES	07364 1110	2,000.00	2,000.00	4,000.00
CONNECTION FEES - SEWER	07364 1130	0.00	0.00	845.64
MISCELLANEOUS REVENUE	07380 1000	1,000.00	0.00	423.36
TRANSFER FROM SEWER OPERATING	07392 0500	125,000.00	0.00	30,700.00
TOTAL REVENUE		130,000.00	2,007.04	35,989.37
EXPENSES				
ADMINISTRATIVE WAGES	07424 1400	37,669.00	8,391.94	16,783.88
MISCELLANEOUS EXPENSE	07424 3000	4,162.00	0.00	950.00
MUNIC.AUTH.-AUDITING	07424 3110	8,843.00	0.00	0.00
ENGINEERING SERVICES	07424 3130	37,066.00	289.75	21,165.00
LEGAL SERVICES	07424 3140	12,485.00	0.00	3,611.68
M.C.-DVRFA-DEBT SERVICE	07471 1000	19,600.00	0.00	0.00
M.C.-DVRFA-INTEREST PAYMN	07472 1000	6,981.00	0.00	0.00
TOTAL EXPENSES		126,806.00	8,681.69	42,510.56
OPERATING NET RESULT		3,194.00	(6,674.65)	(6,521.19)

EAST GOSHEN TOWNSHIP
1580 PAOLI PIKE
WEST CHESTER, PA
Municipal Authority
June 2012

Account Title	Acct #	Annual Budget	Month To Date Actual	Year To Date Actual
CAPITAL BUDGET				
REVENUE				
LOAN PROCEEDS-SEWER PROJECT	07392 0804	0.00	0.00	0.00
TRANSFER FROM SEWER CAP RESERVE	07392 0900	828,000.00	100,000.00	200,000.00
TOTAL REVENUE		828,000.00	100,000.00	200,000.00
EXPENSES				
MARYDELL PUMP STATION - ENGINEER	07425 1000	51,764.00	320.50	2,552.50
MARYDELL PUMP STATION -CONSTRUCTION	07425 2000	170,000.00	0.00	0.00
LOCHWOOD ABANDONMENT ENGINEER	07424 7475	37,553.00	7,527.25	27,373.00
LOCHWOOD ABANDONMENT CONSTRUCTION	07424 7476	411,000.00	105,473.97	105,473.97
LOCHWOOD ELIMINATION PHASE 2	07424 7477	0.00	5,582.68	5,582.68
HERSHEY MILL STATION - ENGINEER	07426 1000	29,069.00	748.50	6,002.75
HERSHEY MILL STATION - CONSTRUCTION	07426 2000	46,000.00	0.00	0.00
RESERVE PUMP STATION - ENGINEER	07427 1000	29,069.00	250.00	4,245.00
RESERVE PUMP STATION - CONSTRUCTION	07427 2000	93,000.00	0.00	0.00
RESERVOIR PUMP STATION - ENGINEER	07428 1000	0.00	0.00	0.00
RESERVOIR PUMP STATION CONSTRUCTION	07428 2000	0.00	0.00	0.00
TOTAL EXPENSES		867,455.00	119,902.90	151,229.90
CAPITAL NET RESULT		(39,455.00)	(19,902.90)	48,770.10
MUNICIPAL AUTHORITY ENDING FUND BALANCE			79,684.88	

*June Beginning Balance does not equal May Ending Balance because \$16.62 was posted in interest after the May report was prepared.

East Goshen Township General Ledger

Report Date 07/03/12

GL Transaction Details

PAGE 1

Acct #	Per	Src	Trx #	Debits	Credits	Beg/End Bal	Date	Check/Ref #	ID #	Name/Description
07341-1000	INTEREST EARNINGS					0.00				
	1201 JE	31221			0.62		02/07/12	INTEREST		INTEREST EARNED JAN. 2012 7100.1000
				0.00	0.62	-0.62				
	1202	31655			0.25		03/14/12	INTEREST		INTEREST EARNED FEB. 2012 7100.1000
				0.00	0.25	-0.87				
	1203	31930			0.56		04/04/12	INTEREST		INTEREST EARNED MARCH 2012 7100.1000
				0.00	0.56	-1.43				
	1204	32293			4.97		05/02/12	INTEREST		INTEREST EARNED APRIL 2012 7100.1000
				0.00	4.97	-6.40				
	1205	32709			6.93		06/05/12	INTEREST		INTEREST EARNED MAY 2012 7100.1000
				0.00	6.93	-13.33				
	1206	33106			7.04		07/03/12	INTEREST		INTEREST EARNED JUNE 2012 7100.1000
				0.00	7.04	-20.37				
				0.00	20.37	-20.37				
07341-1020	INTEREST EARNED - RCSTP EXPANSION					0.00				
	1201	31222			0.40		02/07/12	INTEREST		INTEREST EARNED JAN. 2012 7105.1000
		31223			7.80		02/07/12	INTEREST		INTEREST EARNED JAN. 2012 7109.2000
		31270			0.05		02/09/12	INTEREST		INTEREST EARNED JAN.2012 7105.1500
				0.00	8.25	-8.25				
	1202	31656			0.30		03/14/12	INTEREST		INTEREST EARNED FEB. 2012 7105.1000
		31657			7.30		03/14/12	INTEREST		INTEREST EARNED FEB. 2012 7109.2000
				0.00	7.60	-15.85				
	1203	31931			0.15		04/04/12	INTEREST		INTEREST EARNED MARCH 2012 7105.1000
		31932			9.54		04/04/12	INTEREST		INTEREST EARNED MARCH 2012 7109.2000
				0.00	9.69	-25.54				
	1204	32294			0.14		05/02/12	INTEREST		INTEREST EARNED APRIL 2012 7105.1000

East Goshen Township General Ledger

Report Date 07/03/12

GL Transaction Details

PAGE 2

Acct #	Per	Src Trx #	Debits	Credits	Beg/End Bal	Date	Check/Ref #	ID #	Name/Description
07341-1020	1204	JE 32295		9.52		05/02/12	INTEREST		INTEREST EARNED APRIL 2012 7109.2000
			0.00	9.66	-35.20				
	1205	32710		0.14		06/05/12	INTEREST		INTEREST EARNED MAY 2012 7105.1000
		32711		9.55		06/05/12	INTEREST		INTEREST EARNED MAY 2012 7109.2000
			0.00	9.69	-44.89				
	1206	33107		0.15		07/03/12	INTEREST		INTEREST EARNED JUNE 2012 7105.1000
		33108		9.52		07/03/12	INTEREST		INTEREST EARNED JUNE 2012 7109.2000
			0.00	9.67	-54.56				
			0.00	54.56	-54.56				
07364-1110	R.C.TAPPING FEES				0.00				
	1205	RE 32596		2,000.00		05/25/12	32596 1		TAP IN FEE FOR 1636 MANLEY RD
			0.00	2,000.00	-2,000.00				
	1206	32779		2,000.00		06/11/12	32779 1		TAP IN FEE FOR 913 SORRELL HIL R.C.TAPPING FEES
			0.00	2,000.00	-4,000.00				
			0.00	4,000.00	-4,000.00				
07364-1130	CONNECTION FEES - SEWER				0.00				
	1202	CR 31243		423.00		02/08/12	197	6576	1 JACOBS, ROBERT & CHERYL
		31437		423.00		02/27/12	2103	6575	1 STOFFLET, MICHAEL
		JE 31244	141.12			02/08/12	PINE ROCK		ANNUAL PINE ROCK INSTALLMENT
		31438	141.12			02/27/12	PINE ROCK		ANNUAL PINE ROCK INSTALLMENT
			282.24	846.00	-563.76				
	1203	CR 31489		423.00		03/01/12	730	6574	1 GEORGE SMITH & CHRISTINA CONLE
		JE 31490	141.12			03/01/12	PINE ROCK		ANNUAL PINE ROCK INSTALLMENT
			141.12	423.00	-845.64				
			423.36	1,269.00	-845.64				
07380-1000	MISCELLANEOUS REVENUE				0.00				
	1202	31244		141.12		02/08/12	PINE ROCK		ANNUAL PINE ROCK INSTALLMENT
		31438		141.12		02/27/12	PINE ROCK		ANNUAL PINE ROCK INSTALLMENT
			0.00	282.24	-282.24				
	1203	31490		141.12		03/01/12	PINE ROCK		ANNUAL PINE ROCK INSTALLMENT

East Goshen Township General Ledger

Report Date 07/03/12

GL Transaction Details

PAGE 3

Acct #	Per	Src Trx #	Debits	Credits	Beg/End Bal	Date	Check/Ref #	ID #	Name/Description
			0.00	141.12	-423.36				
			0.00	423.36	-423.36				
07392-0500					0.00				
1202		31428		15,000.00		02/24/12	XFER		XFER FROM 5100.1000 TO 7100.1000
			0.00	15,000.00	-15,000.00				
1203		31612		15,700.00		03/13/12	XFER		XFER FROM 5100.1000 TO 7100.1000 TO COVER MA EXP.
			0.00	15,700.00	-30,700.00				
			0.00	30,700.00	-30,700.00				
07392-0900					0.00				
1204		32045		100,000.00		04/12/12	XFER		XFER \$ FROM SEWER CAP.RESERVE TO MUN.AUTHORITY GEN.ACCT.
			0.00	100,000.00	-100,000.00				
1206		32839		100,000.00		06/15/12	XFER		XFER FUNDS TO MA FROM SEWER CAPITAL RES. 5/14/12
			0.00	100,000.00	-200,000.00				
			0.00	200,000.00	-200,000.00				
07424-1400					0.00				
1203 CD		31601	8,391.94			03/13/12	2085		425 EAST GOSHEN TOWNSHIP 1ST QTR.2012 MUNICIPAL AUTHORITY EXPENSES
			8,391.94	0.00	8,391.94				
1206		32849	8,391.94			06/15/12	2094		425 EAST GOSHEN TOWNSHIP 2ND QTR 2012 MUNICIPAL AUTHORITY EXPENSES
			8,391.94	0.00	16,783.88				
			16,783.88	0.00	16,783.88				
07424-3000					0.00				
1201		30772	950.00			01/06/12	2081		2132 PENNSYLVANIA MUNICIPAL AUTHORITIES ASSOC 2012 ACTIVE MEMBERSHIP DUES
			950.00	0.00	950.00				
			950.00	0.00	950.00				

East Goshen Township General Ledger

Report Date 07/03/12

GL Transaction Details

PAGE 4

Acct #	Per	Src Trx #	Debits	Credits	Beg/End Bal	Date	Check/Ref #	ID #	Name/Description
07424-3130					0.00				
									ENGINEERING SERVICES
1202		31393	220.00			02/22/12	2084	1052	PENNONI ASSOCIATES INC. SERV.THRU 1/15/12 2011 ANNUAL SE
			220.00	0.00	220.00				
1203		31608	1,182.50			03/13/12	2086	1052	PENNONI ASSOCIATES INC. SERVICES THRU 12/11/12 2011 ANN SERVICES
			1,182.50	0.00	1,402.50				
1204		32043	4,971.75			04/12/12	2088	1052	PENNONI ASSOCIATES INC. SERVICES THRU 3/18/12 2012 GEN.S
			4,971.75	0.00	6,374.25				
1205		32450	14,501.00			05/15/12	2090	1052	PENNONI ASSOCIATES INC. SERVICE THRU 4/15/12 2011 CHAP.9
			14,501.00	0.00	20,875.25				
1206		32809	289.75			06/14/12	2092	1052	PENNONI ASSOCIATES INC. SERVICES THRU 5/13/12 GENERAL SE
			289.75	0.00	21,165.00				
			21,165.00	0.00	21,165.00				
07424-3140					0.00				
									LEGAL SERVICES
1202		31393	1,825.68			02/22/12	2083	528	GANTHROP GREENWOOD & HALSTED LEGAL SERV. 12/12/11 - GEN.AUTH.
			1,825.68	0.00	1,825.68				
1204		32043	1,083.00			04/12/12	2087	528	GANTHROP GREENWOOD & HALSTED LEGAL SERVICE 2/7-2/29/12 GEN.AU
			1,083.00	0.00	2,908.68				
1205		32450	703.00			05/15/12	2089	528	GANTHROP GREENWOOD & HALSTED LEGAL SERV. 3/12-3/21/12 GEN.AUT
			703.00	0.00	3,611.68				
			3,611.68	0.00	3,611.68				
07424-7453					0.00				
									R.C. CAP EXPANSION - ELECTRICAL
1206		32809	1,228.08			06/14/12	2091	2696	CLINGER CORP., WM. H. REPAIR TANK MIXER CONTROL CIRCUIT FAULT
			1,228.08	0.00	1,228.08				
			1,228.08	0.00	1,228.08				

Report Date 07/03/12

GL Transaction Details

PAGE 5

Acct #	Per	Src	Trx #	Debits	Credits	Beg/End Bal	Date	Check/Ref #	ID #	Name/Description
07424-7475	LOCHWOOD	ABANDONMENT ENGINEER				0.00				
	1202	31393		2,600.00			02/22/12	2082	2911	EARTHORE SERVICES LLC MOBILIZATION, ATV RIG, AUGER PRO LOCKWOOD ENGINEERING
				4,315.00			02/22/12	2084	1052	PENNONI ASSOCIATES INC. SERV. THRU 1/15/12 LCSTP FINAL D
		***		6,915.00	0.00	***				
				6,915.00	0.00	6,915.00				
1203	31608			7,440.50			03/13/12	2086	1052	PENNONI ASSOCIATES INC. SERVICES THRU 12/11/12 LCSTP FI DESIGN
				7,440.50	0.00	14,355.50				
1204	32043			1,366.00			04/12/12	2088	1052	PENNONI ASSOCIATES INC. SERVICES THRU 3/18/12 LOCKWOOD
				1,366.00	0.00	15,721.50				
1205	32450			4,124.25			05/15/12	2090	1052	PENNONI ASSOCIATES INC. SERVICES THRU 4/15/12 LCSTP
				4,124.25	0.00	19,845.75				
1206	32809			7,527.25			06/14/12	2092	1052	PENNONI ASSOCIATES INC. SERVICES THRU 5/31/12 TO ACCOMADATE INCREASE IN FLOW TO P
				7,527.25	0.00	27,373.00				
				27,373.00	0.00	27,373.00				
07424-7476	LOCHWOOD	ABANDONMENT CONSTRUCTION				0.00				
				105,473.97			06/14/12	2093	2947	SJM CONSTRUCTION CO. INC. APPLICATION 1 OF CONTRACT
				105,473.97	0.00	105,473.97				
				105,473.97	0.00	105,473.97				
07424-7477	LOCHWOOD	ELIMINATION PHASE 2				0.00				
		33040		352.68			06/29/12	2095	765	LENNI ELECTRIC CORPORATION SET UP TEMPORARY PUMP - LOCKWOOD
				450.00			06/29/12	2096	2342	POWERPRO EQUIPMENT 50 HYDRATED WHITE - LOCKWOOD PLA CLOSURE
				4,780.00			06/29/12	2097	550	XYLEM DEWATERING SOLUTIONS INC. (GODWIN) GODWIN SUBMERSIBLE PUMP & CONTRO PANEL, HEAVY DUTY LAYFLAT HOSE
		***		5,582.68	0.00	***				
				5,582.68	0.00	5,582.68				

Report Date 07/03/12

GL Transaction Details

PAGE 6

Acct #	Per	Src Trx #	Debits	Credits	Beg/End Bal	Date	Check/Ref #	ID #	Name/Description
			5,582.68	0.00	5,582.68				
07425-1000					0.00				
1203		31608	810.00			03/13/12	2086	1052	PENNONI ASSOCIATES INC. SERVICES THRU 12/11/12 MARYDELL
			810.00	0.00	810.00				
1204		32043	1,422.00			04/12/12	2088	1052	PENNONI ASSOCIATES INC. SERVICES THRU 3/18/12 MARYDELL P
			1,422.00	0.00	2,232.00				
1206		32809	320.50			06/14/12	2092	1052	PENNONI ASSOCIATES INC. SERVICES THRU 5/13/12 MARYDELL
			320.50	0.00	2,552.50				
			2,552.50	0.00	2,552.50				
07426-1000					0.00				
1203		31608	2,336.75			03/13/12	2086	1052	PENNONI ASSOCIATES INC. SERVICES THRU 12/11/12 HERSHEY
			2,336.75	0.00	2,336.75				
1205		32450	2,917.50			05/15/12	2090	1052	PENNONI ASSOCIATES INC. SERVICE THRU 4/15/12 HERSHEY MIL
			2,917.50	0.00	5,254.25				
1206		32809	498.50			06/14/12	2092	1052	PENNONI ASSOCIATES INC. SERVICES THRU 5/13/12 HERSHEY MI
		33047	250.00			06/29/12	2099	263	CHESTER COUNTY CONSERVATION DISTRICT PERMIT FEE HM PS PROJECT
			748.50	0.00	6,002.75				
			6,002.75	0.00	6,002.75				
07427-1000					0.00				
1203		31608	605.00			03/13/12	2086	1052	PENNONI ASSOCIATES INC. SERVICES THRU 12/11/12 RESERVE
			605.00	0.00	605.00				
1204		32043	472.50			04/12/12	2088	1052	PENNONI ASSOCIATES INC. SERVICES THRU 3/18/12 RESERVE PU
			472.50	0.00	1,077.50				
1205		32450	2,917.50			05/15/12	2090	1052	PENNONI ASSOCIATES INC. SERVICE THRU 4/15/12 RESERVE PS
			2,917.50	0.00	3,995.00				

East Goshen Township General Ledger

Report Date 07/03/12

GL Transaction Details

PAGE 7

Acct #	Per	Src	Trx #	Debits	Credits	Beg/End Bal	Date	Check/Ref #	ID #	Name/Description
07427-1000	1206	CD	33047	250.00			06/29/12	2098		263 CHESTER COUNTY CONSERVATION DISTRICT PERMIT FEE RESERVE PS PROJECT
				250.00	0.00	4,245.00				
				4,245.00	0.00	4,245.00				
Beg Bal		0.00	195,391.90	236,467.29	-41,075.39					

Memo

To: Municipal Authority

From: Tia Piccolo

Date: July 5, 2012

Re: Lochwood Plant Closing Labor Costs as of 6/30/12

Please note that as of 6/30/12 \$7,780.40 has been reported in labor and equipment costs related to the closing of the Lochwood Plant.

We recommend that the Municipal Authority approve these charges.

Employees	Reg	OT
Total Hours	127	12
Total Cost	3,954.36	560.10

Equipment	
Total Hours	55.5
Total Cost	3,265.94

Rick Smith

From: Ellis, Michael <MEllis@Pennoni.com>
Sent: Thursday, July 05, 2012 10:36 AM
To: rsmith@eastgoshen.org
Cc: Barbato, Daniel; Mark Miller (mmiller@eastgoshen.org)
Subject: Sewer Diversion Schedules

Rick,

Following are projected schedules for the Marydell, Reserve, and Hershey Mill sewer diversions.

Marydell

- Test pits = by July 31, 2012
- HOP application for sewer installation = by July 31, 2012
- DEP Closure Plan submission = July 31, 2012
- HOP permit issuance = by August 31, 2012
- DEP Closure Plan approval (90-120 days) = October-November 2012
- Additional Easement from shopping center = October-November 2012
- Advertise = December 2012
- Bids Due = January 2013
- Contract Execution (after bonding and insurance) = February 2013
- Start Construction = March 2013
- Complete Construction (say 120 days) = July 2013

Hershey Mill

- GP-5 application to DEP for stream crossing = Done (June 22, 2012)
- E&S submission to CCCD = July 6, 2012
- Rock borings = by July 31, 2012
- DEP Part 2 WQM Permit Amendment submission = by July 31, 2012
- CCCD E&S approval (± 60 days) = September 2012
- DEP GP-5 approval (following CCCD approval) = September 2012
- DEP Part 2 WQM Permit Amendment approval (120 days) = November 2012
- Advertise = December 2012
- Bids Due = January 2013
- Contract Execution (after bonding and insurance) = February 2013
- Start Construction = March 2013
- Complete Construction (say 120 days) = July 2013

Reserve

- GP-5 application to DEP for stream crossing = Done (June 27, 2012)
- E&S submission to CCCD = July 6, 2012
- Rock borings = by July 31, 2012
- DEP Closure Plan submission = by July 31, 2012
- CCCD E&S approval (± 60 days) = September 2012
- DEP GP-5 approval (following CCCD approval) = September 2012
- DEP Closure Plan approval (90-120 days) = October-November 2012
- **3-4 MONTH HOLD FOR OTHER PROJECTS TO BID AND BE AWARDED***
- Advertise = March 2013

- Bids Due = April 2013
- Contract Execution (after bonding and insurance) = May 2013
- Start Construction = June 2013
- Complete Construction (say 120 days) = October 2013

*We have previously discussed the potential to bid Marydell and Reserve under one contract for economy of scale. After further consideration, I suggest they be bid separately. The contract duration would have to be extended to 6-8+ months if they are done together versus approx 4 months for only one project. The contractor may also not be able to handle both projects concurrently, and separate contracts would diversify the risk in case there are any performance issues with one contractor. Further, if Reserve is bid out after Marydell is awarded, there is still a potential for economy of scale as the Marydell contractor could bid the Reserve project anyway at economical costs since he will already be in the township. I'm therefore proposing the Reserve bidding be pushed back 3-4 months so that there are not 3 projects out to bid at the same time (for conflicts/delays with contractual issues, coordination, inspections, etc.), and to allow the same contractors to bid and not have to work the entirety of both jobs concurrently.

Hershey Mill will be bid separate of the other two because it is a directional drill contract and is expected to involve a different, specialty prime contractor than the other two diversions.

Mike

Michael J. Ellis, PE

Pennoni Associates Inc.

Christiana Executive Campus
121 Continental Drive, Suite 207
Newark, DE 19713-4310

Office 302-655-4451 x5236 | Direct 302-351-5236

Fax 302-654-2895 | Mobile 302-561-4235

<http://www.pennoni.com> | mellis@pennoni.com

Consulting Engineers providing...

*Environmental – Geotechnical – Inspection & Testing – Land Development – MEP
Landscape Architecture – Structural – Survey – Transportation – Water/Wastewater*

JULY 2012
EAST GOSHEN MUNICIPAL AUTHORITY GOALS

ON-GOING

1. Submit an article for each newsletter.
 - a. Need by 2/8/12 - Kevin - **Completed**
 - b. Need by 5/2/12 –Jack - **Completed**
 - c. Need by 8/1/12 - Dana
 - d. Need by 11/7/12
 - e. February 2013
2. Attend West Goshen Meetings quarterly – more often if needed.
 - a. 1st Quarter (March) – Jack - **Completed**
 - b. 2nd Quarter (June) – Joe – Not completed
 - c. 3rd Quarter (September) - Dana
 - d. 4th Quarter (December) - Kevin
3. Respond to capacity requests in 45 days or less.
4. Implement I & I Plan
5. Conduct a sewer facilities tour after RCSTP construction is complete – Have tour in September

PROJECTS

1. Lockwood
 - a. Bid – Bid awarded 2/20 – Contract executed 3/12
 - b. Pipe Installation - Notice to proceed issued 3/20, Pipe work completed. Restoration work in progress
2. **Abandon Plant – Treatment pond filled in. Currently pumping down the and filling in the storage lagoon.**
3. Marydell Pump Station
 - a. Design/Permit – In Progress
 - b. Bid
 - c. Pipe Installation
 - d. Abandon Pump Station
4. Hershey Mill Pump Station
 - a. Design/Permit – In Progress
 - b. Bid
 - c. Pipe Installation
5. Reserve Pump Station - In Progress
 - a. Design/Permit
 - b. Bid
 - c. Pipe Installation
 - d. Abandon Pump Station

RESOLUTION 31
OF THE EAST GOSHEN MUNICIPAL AUTHORITY
CHESTER COUNTY, PENNSYLVANIA

A RESOLUTION THAT DECLARES THE OFFICIAL INTENT OF THE EAST GOSHEN MUNICIPAL AUTHORITY (THE "MUNICIPAL AUTHORITY") TO ADOPT CERTAIN FINANCIAL POLICIES AND PRODECURES.

WHEREAS, the "Municipal Authority" was created pursuant to the provisions of the Municipality Authorities Act, approved May 2, 1945 (P.L. 382, No. 164, as amended); and

WHEREAS, the "Municipal Authority" was issue a Certificate of Incorporation by the Commonwealth of Pennsylvania on May 23, 1967 and pursuant to said Certificate shall exist for a term of 50 years; and

WHEREAS, the "Municipal Authority" was issued a Certificate of Amendment by the Commonwealth of Pennsylvania on August 6, 1998 and that extended the term until July 1, 2048; and

WHEREAS, the Municipal Authority is subject to the provisions of the Municipality Authorities Act, as well as various other state and federal laws and/or regulations that impose financial requirements on the Municipal Authority; and

WHEREAS, the Municipal Authority has previously authorized the Township Manager to incur expenses of a maximum of five thousand dollars (\$5,000.00) on behalf of the Municipal Authority; and

WHEREAS, the Municipal Authority has determined that it should formally adopt policies and procedures for various financial activities.

NOW, THEREFORE, BE IT RESOLVED BY THE BOARD OF THE EAST GOSHEN MUNICIPAL AUTHORITY, THAT:

1. The Township Manager is authorized to incur a maximum of \$5,000 of expenses on behalf of the Authority. The Township shall advise the Municipal Authority of any such incurrence at their next scheduled meeting.

2. The Municipal Authority will adhere to purchasing and bidding requirements established by the Commonwealth of Pennsylvania.
3. The Municipal Authority shall, at a public meeting, approve all invoices prior to payment, except for Debt Service payments.
4. The Township Manager is authorized to receive and open sealed bids on behalf of the Municipal Authority.
5. All Resolutions or parts of resolutions not in accord with this Resolution are hereby repealed insofar as they conflict herewith.

IN WITNESS WHEREOF, we, the undersigned authorized officials of the East Goshen Municipal Authority, Chester County, Commonwealth of Pennsylvania, have hereunto set our signatures and affixed hereto the Seal of the Municipal Authority.

Dated: July _____, 2012

Dana Pizarro
Chairman
East Goshen Municipal Authority

[Seal]

ATTEST:

Secretary
East Goshen Municipal Authority

Memorandum

East Goshen Township
1580 Paoli Pike
West Chester, PA 19380

Voice: 610-692-7171
Fax: 610-692-8950
E-mail: mgordon@eastgoshen.org

Date: 6/21/2012
To: Municipal Authority
From: Mark Gordon, Township Zoning Officer *male*
Re: Goshen Meadows / Cond. Use Application / 1325 West Chester Pike

Please review the Conditional Use plan for 1325 West Chester Pike. The applicant has requested sewage flow allocation for the new 64 unit Apartment Community.

I have forwarded the allocation request and exemption request and supporting information to Mr. Scott at West Goshen for his review. The Municipal Authority needs to approve the allocation and verify the conveyance is adequate for the proposed flows.

BOARD OF SUPERVISORS

EAST GOSHEN TOWNSHIP

CHESTER COUNTY

1580 PAOLI PIKE, WEST CHESTER, PA 19380-6199

June 21, 2012

West Goshen Township

ATTN: Mr. John Scott

1025 Paoli Pike

West Chester, Pa. 19380-4699

COPY

Re: Sewer Capacity / Goshen Meadows Apartments

Dear Mr. Scott:

East Goshen Township is currently reviewing a Conditional Use application for a new Apartment Community at 1325 West Chester Pike. The applicant, Goshen Meadows Investors LP., proposes to develop the five acre site adjacent to the existing Goshen Meadows Apartment Community. The plan proposes to add five (5) apartment buildings consisting of sixty (60), two bedroom apartment units and convert the existing historic home into four (4), one bedroom apartment units.

Please review the enclosed request for sewer capacity and the sewer facilities planning module exemption request from the applicant. As you know the Township will need a letter from your office along with the completed forms in order to move forward with the plan review process.

The East Goshen Municipal Authority will meet on July 9, 2012 to make a recommendation on this application and the Planning Commission will make a final recommendation on this application to the Board of Supervisors at their meeting on July 11, 2012. Please contact me if you have any questions.

Sincerely,



Mark A. Gordon
Township Zoning Officer

610-356-9550
FAX 610-356-5032

Herbert E. MacCombie, Jr., P.E.

CONSULTING ENGINEERS & SURVEYORS, INC.
1000 PALMERS MILL ROAD
MEDIA, PA 19063

James W. MacCombie, P.E., P.L.S.
Herbert E. MacCombie, III, Technician

REPLY TO:
P.O. BOX 118
BROOMALL, PA 19008-0118

RECEIVED
BY _____
JUN 15 2012

June 15, 2012

East Goshen Township
1580 Paoli Pike
West Chester, PA 19380

East Goshen Township Municipal Authority
East Goshen Township
1580 Paoli Pike
West Chester, PA 19380

Attn: Mark A. Gordon, Director of Code Enforcement, Zoning Officer

Re: Sewage Flow Allocation
Plan of Proposed Planned Apartment Development - Smith Tract
West Chester Pike
East Goshen Township, Chester County, PA

Dear Mr. Gordon:

Please be advised that our client, Goshen Meadows L.P., has made application to East Goshen Township for Conditional Use Approval for a proposed planned apartment development. In accordance with Act 537, as amended by Act 149, it is hereby respectfully requested that consideration be given to granting an exemption from submitting Sewage Facilities Planning Modules. It is further requested that provisions for appropriate flow allocation for the proposed development also be considered.

The proposed development proposes 60 two-bedroom luxury apartments in five buildings and the adaptive reuse of the existing historic structure with four one-bedroom luxury apartments. The proposed development of 64 units will generate 200 GPD per unit for a total of 12,800 GPD. Please refer to the enclosed letter from PaDEP to Pennsylvania American Water Company, dated May 29, 2008 regarding the allocation of flow for planning purposes. All of the proposed sewage will ultimately enter the East Goshen Township sanitary sewer system. A copy of the Plan of Proposed Improvements is included for your use.

June 15, 2012

Proposed Planned Apartment Development - Smith Tract

Page 2

Also enclosed, please find the completed PaDEP mailer for signature by the Township at the appropriate time, completed PNDI review and USGS Quad Map.

Please contact our office if you have any questions.

Very truly yours,

A handwritten signature in dark ink, appearing to read "Dennis F. O'Neill", written over a horizontal line.

Dennis F. O'Neill, P.E.

Copy: Scott Fagan
Mark Thompson, Esq.

1. Development Information

Name of Development Prop. Apartment Complex Smith Tract
 Developer Name Goshen Meadows Investors, L.P.
 Address C/O Scott Fagan, P.O. Box 446
Narberth, PA 19072
 Telephone # 610-667-1700 x 305
 Email asf@mmcrent.com

2. Location of Development

- a. County Chester
 b. Municipality East Goshen Township
 c. Address or Coordinates West Chester Pike at Mary Fran Drive
 d. Tax Parcel # 53-06-56.1
 e. USGS Quad Name West Chester
inches up 16.6 over 6.8
from bottom right corner of map.
 f. Located in a High Quality/Exceptional Value watershed?
☐ Yes ☐ No

3. Type of Development Proposed (check appropriate box)

- ☐ Residential ☒ Multi-Residential
 Describe 60 2 bedroom apartments in five proposed building - conversion of ex bldg into 4 1 bedroom apart.
☐ Commercial ☐ Institutional
 Describe _____
☐ Brownfield Site Redevelopment
☐ Other (specify) _____

4. Size

- a. # of lots 1 # of EDUs 64
 b. # of lots since 5/15/72 1
 c. Development Acreage 5.12
 d. Remaining Acreage 0

5. Sewage Flows 12,800 gpd**6. Proposed Sewage Disposal Method (check applicable boxes)**

- a. ☒ Sewerage System
☐ Existing (connection only) ☒ New (extension)
☒ Public ☐ Private
☐ Pump Station(s)/Force Main ☒ Gravity
 Name of existing system being extended
East Goshen Municipal Authority
 Interceptor Name _____
 Treatment Facility Name _____
 NPDES Permit # _____
 b. ☐ Construction of Treatment Facility
☐ With Stream Discharge
☐ With Land Application (not including IRSIS)
☐ Other
☐ Repair?
 Name of waterbody where point of discharge is proposed (if stream discharge)

- c. ☐ Onlot Sewage Disposal Systems
 (check appropriate box)
☐ Individual onlot system(s) (including IRSIS)
☐ Community onlot system
☐ Large-Volume onlot system

d. ☐ Retaining tanks

Number of Holding Tanks _____
 Number of Privies _____

7. ☐ Request Sewage Facilities Planning Module forms in electronic format**8. Request for Planning Exemption**

- a. Protection of rare, endangered or threatened species

Check one:

- ☒ The "PNDI Project Environmental Review Receipt" is attached.
 or
☐ A completed "PNDI Project Planning & Environmental Review Form," (PNDI Form) is attached. I request DEP staff to complete the required PNDI search for my project. I realize that my planning exemption will be considered incomplete and that the DEP processing of my planning exemption request will be delayed, until a "PNDI Project Environmental Review Receipt" and all supporting documentation from jurisdictional agencies (when necessary) is/are received by DEP.

Applicant or Consultant Initials _____

- b. ☒ Plot Plan Attached ☒ Site Reports Attached

c. Onlot Disposal Systems

- (1) I certify that the Official Plan shows this area as an onlot service area.

 (Signature of Municipal Official) Date

 Name (Print) Title

Municipality (must be same as in 2.b.)

Telephone # _____

- (2) I certify that each lot in this subdivision has been tested and is suitable for both a primary and replacement sewage disposal system.

 Signature of SEO Date

 Name (Print) Certification #

Telephone # _____

- (3) I certify that each lot in this subdivision is at least 1 acre in size

 (Signature of Project Applicant/Agent) Date

- d. Public Sewerage Service (i.e., ownership by municipality or authority)

Based upon written documentation, I certify that the facilities proposed for use have capacity and that no overload exists or is projected within 5 years. (Attach documents.)

 (Signature of Municipal Official) Date
Rick Smith / Township Manager
 Name (Print) Title

East Goshen Township
 Municipality (must be same as in 2.b.)

Telephone # 610-692-7171

Return Correspondence/Forms to:

DEPARTMENT OF ENVIRONMENTAL PROTECTION

DEP USE	
Components Sent	
Onlot Disposal	<input type="checkbox"/>
Collection and Treatment	<input type="checkbox"/>
Planning Agency Review	<input type="checkbox"/>
Exempt from Planning	<input type="checkbox"/>
Code _____	
Date _____	

"Fold Here"



WEST CHESTER QUADRANGLE PENNSYLVANIA 7.5 MINUTE SERIES (TOPOGRAPHIC)

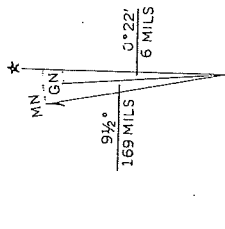

SE 2.8 MI. TO U.S. 30 32° 30' PA. TURNPIKE (INTERCHANGE NO. 24) 11 MI. 75° 30'

SCALE 1:24000

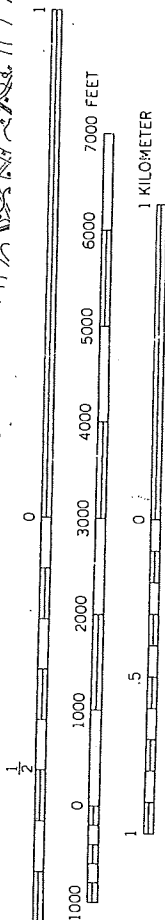

CONTOUR INTERVAL 10 FEET
NATIONAL GEODETIC VERTICAL DATUM OF 1929

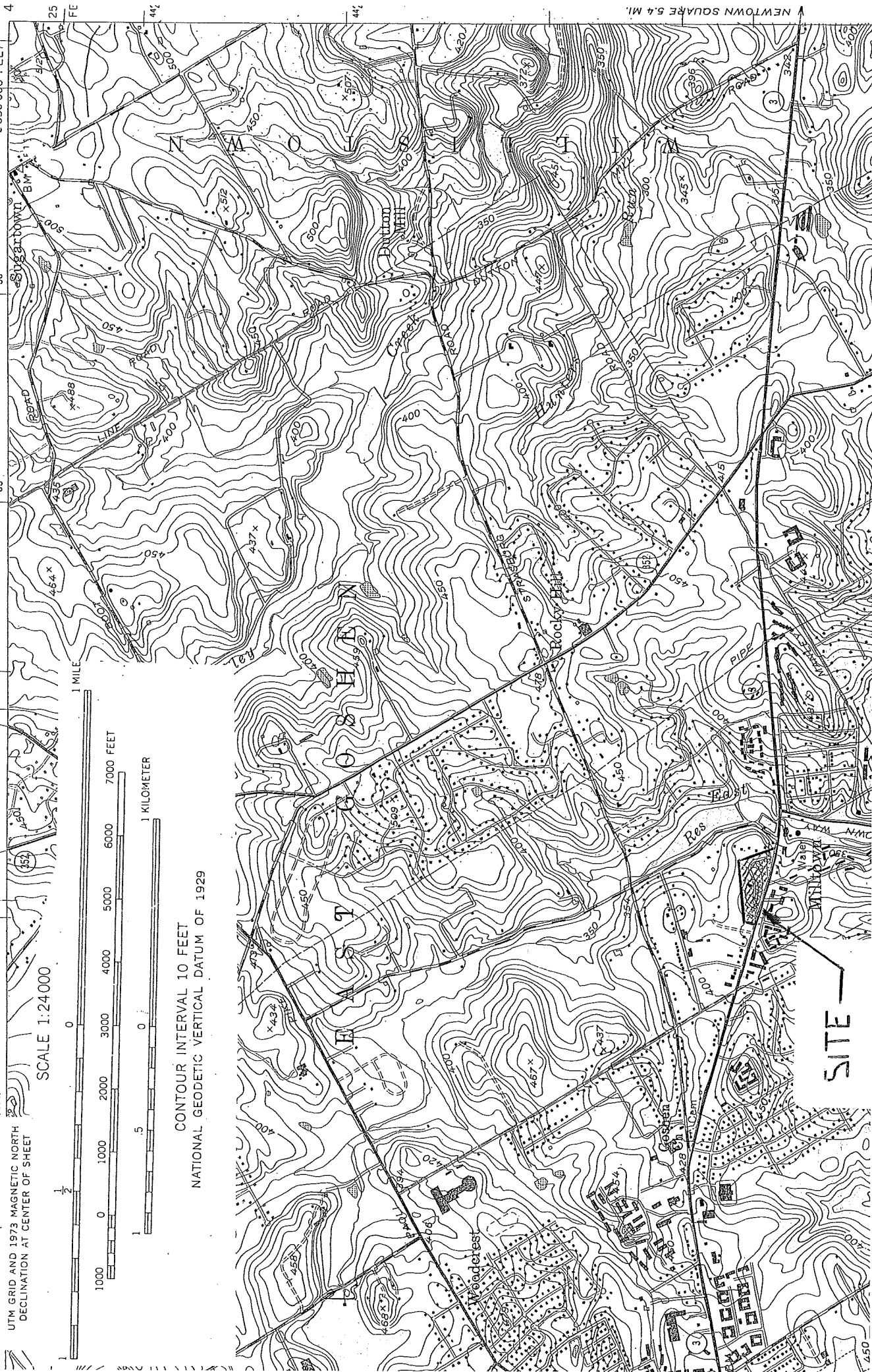



Pennsylvania Department of Environmental Protection

2 East Main Street
Norristown, PA 19401
May 29, 2008

Southeast Regional Office

Phone: 484-250-5970
Fax: 484-250-5971

Mr. Wayne G. "Ted" Reed, Manager
Pennsylvania American Water
100 Cheshire Court, Suite 104
Coatesville, PA 19320

Re: Request for Revised EDU Capacity
PAWC – Coatesville WWTP
City of Coatesville
Chester County

Dear Mr. Reed:

This is in response to your January 24, 2008, request for a revision of the flow assigned per Equivalent Dwelling Unit (EDU) type as it relates to sewer capacity in the expanded Coatesville WWTP. Your request included a year-long flow study for two subdivisions and an apartment complex within your service area. Based on meter readings from these three study sites, Pennsylvania American Water Company (PAWC) requested approval to use the following flow per EDU:

- | | |
|----------------------------|---------|
| • All Single Family Units | 200 gpd |
| • Senior Housing | 150 gpd |
| • Townhouses (1-2 Bedroom) | 175 gpd |
| • All Apartment Units | 175 gpd |

The Department of Environmental Protection (Department) has reviewed your data, your conclusions, and the justifications for reducing the flow per EDU for the various types of dwellings listed above. We agree that the new pipe standards, installation, and testing methods combined with the requirement for low flow fixtures in new construction can reduce the expected flow per unit. However, long-term performance and maintenance of this pipe material also play an integral role in determining future flows. In addition, local enforcement of ordinances prohibiting residents from directing roof leaders and sump pumps into the sewage collection system is an important aspect to consider in determining planning flows.

Based on these uncertain factors and based also on the fact that the planning process is intended to provide for adequate capacity for years into the future, we suggest that the following minimum flow per EDU may be approved in planning for the Coatesville STP in lieu of the 262.5 gpd/EDU previously required by policy:

- All Single Family Units 225 gpd
- Senior Housing 200 gpd
- Townhouses (1-2 Bedroom) 200 gpd
- All Apartment Units 200 gpd

The Department believes that this reduction in flow per EDU below 262.5 gpd/EDU will meet both the needs of PAWC and contributing municipalities, as well as the intent of the sewage planning program. We appreciate the opportunity to work with PAWC on this issue. We hope that these flow numbers will enable PAWC and the contributing municipalities to work towards a regional 537 plan update that will provide for exceptional sewer service for many years.

If you have any questions, please contact myself or Ms. Elizabeth Mahoney at 484-250-5177.

Sincerely,

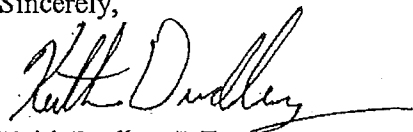

Keith Dudley, P.E.
Environmental Engineer Manager
Municipal Planning and Finance Section
Water Management

cc: Mr. DeBalko, P.E. – PAWC
Mr. Corbett – URS Corporation
Mr. Feola – DEP
Ms. Fields, P.E. – DEP
Ms. Mahoney – DEP
Re 30 (GJS08)149

1. PROJECT INFORMATION

Project Name: **Goshen Meadows 2**

Date of review: **6/14/2012 11:03:59 AM**

Project Category: **Development, Residential, Subdivision containing more than 2 lots and/or 2 single-family units**

Project Area: **6.6 acres**

County: **Chester** Township/Municipality: **East Goshen**

Quadrangle Name: **WEST CHESTER** ~ ZIP Code: **19382**

Decimal Degrees: **39.966595 N, -75.549330 W**

Degrees Minutes Seconds: **39° 57' 59.7" N, -75° 32' 57.6" W**

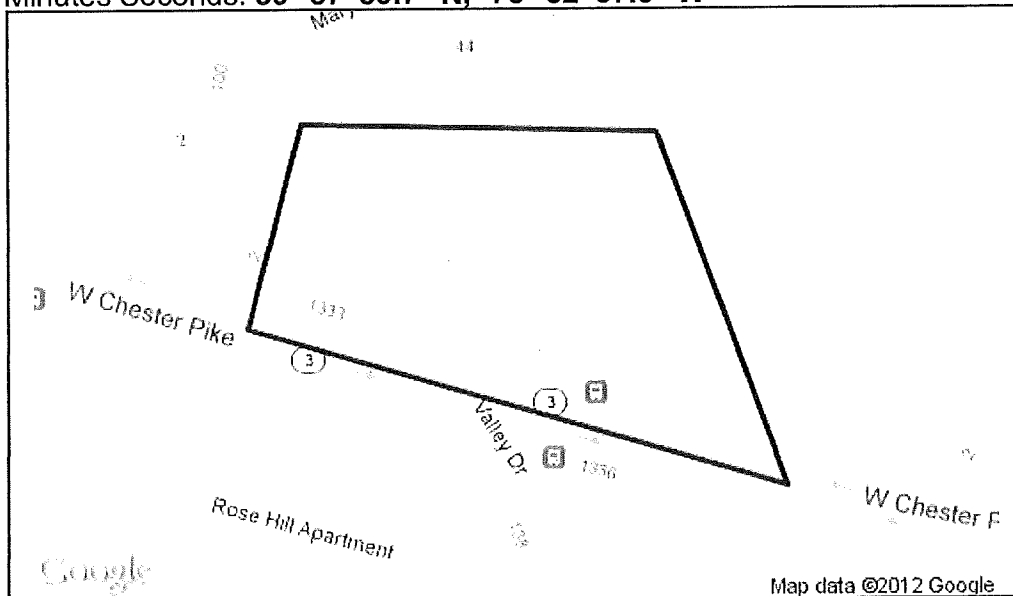

2. SEARCH RESULTS

Agency	Results	Response
PA Game Commission	No Known Impact	No Further Review Required
PA Department of Conservation and Natural Resources	No Known Impact	No Further Review Required
PA Fish and Boat Commission	No Known Impact	No Further Review Required
U.S. Fish and Wildlife Service	No Known Impact	No Further Review Required

As summarized above, Pennsylvania Natural Diversity Inventory (PNDI) records indicate no known impacts to threatened and endangered species and/or special concern species and resources within the project area. Therefore, based on the information you provided, no further coordination is required with the jurisdictional agencies. This response does not reflect potential agency concerns regarding impacts to other ecological resources, such as wetlands.

Note that regardless of PNDI search results, projects requiring a Chapter 105 DEP individual permit or GP 5, 6, 7, 8, 9 or 11 in certain counties (Adams, Berks, Bucks, Carbon, Chester, Cumberland, Delaware, Lancaster, Lebanon, Lehigh, Monroe, Montgomery, Northampton, Schuylkill and York) must comply with the bog turtle habitat screening requirements of the PASPGP.

RESPONSE TO QUESTION(S) ASKED

Q1: Accurately describe what is known about wetland presence in the project area or on the land parcel by selecting ONE of the following. "Project" includes all features of the project (including buildings, roads, utility lines, outfall and intake structures, wells, stormwater retention/detention basins, parking lots, driveways, lawns, etc.), as well as all associated impacts (e.g., temporary staging areas, work areas, temporary road crossings, areas subject to grading or clearing, etc.). Include all areas that will be permanently or temporarily affected -- either directly or indirectly -- by any type of disturbance (e.g., land clearing, grading, tree removal, flooding, etc.). Land parcel = the lot(s) on which some type of project(s) or activity(s) are proposed to occur.

Your answer is: **3. Someone qualified to identify and delineate wetlands has investigated the site, and determined that NO wetlands are located in or within 300 feet of the project area. (A written report from the wetland specialist, and detailed project maps should document this.)**

Q2: Describe how wastewater (effluent) will be handled (select one). For the purpose of this question, wastewater/effluent does not include stormwater runoff. If the project involves solely the renewal or modification of an existing discharge permit (e.g., NPDES permit), select from options 3, 4, 5, or 6 below.

Your answer is: **2. All wastewater/effluent from this project/activity will be routed to an existing municipal wastewater treatment plant.**

Q3: Are there any perennial or intermittent waterways (rivers, streams, creeks, tributaries) in or near the project area, or on the land parcel?

Your answer is: **2. No**

Q4: Which of the following closest describes the proposed project?

Your answer is: **2. The proposed project will be connected to, and entirely serviced by, an existing, off-site water delivery and supply line (e.g., operated by a municipality or water company).**

3. AGENCY COMMENTS

Regardless of whether a DEP permit is necessary for this proposed project, any potential impacts to threatened and endangered species and/or special concern species and resources must be resolved with the appropriate jurisdictional agency. In some cases, a permit or authorization from the jurisdictional agency may be needed if adverse impacts to these species and habitats cannot be avoided.

These agency determinations and responses are **valid for one year** (from the date of the review), and are based on the project information that was provided, including the exact project location; the project type, description, and features; and any responses to questions that were generated during this search. If any of the following change: 1) project location, 2) project size or configuration, 3) project type, or 4) responses to the questions that were asked during the online review, the results of this review are not valid, and the review must be searched again via the PNDI Environmental Review Tool and resubmitted to the jurisdictional agencies. The PNDI tool is a primary screening tool, and a desktop review may reveal more or fewer impacts than what is listed on this PNDI receipt. The jurisdictional agencies **strongly advise against** conducting surveys for the species listed on the receipt prior to consultation with the agencies.

PA Game Commission

RESPONSE: No Impact is anticipated to threatened and endangered species and/or special concern species and resources.

PA Department of Conservation and Natural Resources

RESPONSE: No Impact is anticipated to threatened and endangered species and/or special concern species and resources.

PA Fish and Boat Commission

RESPONSE: No Impact is anticipated to threatened and endangered species and/or special concern species and resources.

U.S. Fish and Wildlife Service

RESPONSE: No impacts to federally listed or proposed species are anticipated. Therefore, no further consultation/coordination under the Endangered Species Act (87 Stat. 884, as amended; 16 U.S.C. 1531 *et seq.*) is required. Because no take of federally listed species is anticipated, none is authorized. This response does not reflect potential Fish and Wildlife Service concerns under the Fish and Wildlife Coordination Act or other authorities.

4. DEP INFORMATION

The Pa Department of Environmental Protection (DEP) requires that a signed copy of this receipt, along with any required documentation from jurisdictional agencies concerning resolution of potential impacts, be submitted with applications for permits requiring PNDI review. For cases where a "Potential Impact" to threatened and endangered species has been identified before the application has been submitted to DEP, the application should not be submitted until the impact has been resolved. For cases where "Potential Impact" to special concern species and resources has been identified before the application has been submitted, the application should be submitted to DEP along with the PNDI receipt. The PNDI Receipt should also be submitted to the appropriate agency according to directions on the PNDI Receipt. DEP and the jurisdictional agency will work together to resolve the potential impact(s). See the DEP PNDI policy at <http://www.naturalheritage.state.pa.us>.

5. ADDITIONAL INFORMATION

The PNDI environmental review website is a **preliminary** screening tool. There are often delays in updating species status classifications. Because the proposed status represents the best available information regarding the conservation status of the species, state jurisdictional agency staff give the proposed statuses at least the same consideration as the current legal status. If surveys or further information reveal that a threatened and endangered and/or special concern species and resources exist in your project area, contact the appropriate jurisdictional agency/agencies immediately to identify and resolve any impacts.

For a list of species known to occur in the county where your project is located, please see the species lists by county found on the PA Natural Heritage Program (PNHP) home page (www.naturalheritage.state.pa.us). Also note that the PNDI Environmental Review Tool only contains information about species occurrences that have actually been reported to the PNHP.

6. AGENCY CONTACT INFORMATION

PA Department of Conservation and Natural Resources

Bureau of Forestry, Ecological Services Section
400 Market Street, PO Box 8552, Harrisburg, PA.
17105-8552
Fax:(717) 772-0271

U.S. Fish and Wildlife Service

Endangered Species Section
315 South Allen Street, Suite 322, State College, PA.
16801-4851
NO Faxes Please.

PA Fish and Boat Commission

Division of Environmental Services
450 Robinson Lane, Bellefonte, PA. 16823-7437
NO Faxes Please

PA Game Commission

Bureau of Wildlife Habitat Management
Division of Environmental Planning and Habitat Protection
2001 Elmerton Avenue, Harrisburg, PA. 17110-9797
Fax:(717) 787-6957

7. PROJECT CONTACT INFORMATION

Name: _____
Company/Business Name: _____
Address: _____
City, State, Zip: _____
Phone:() _____ Fax:() _____
Email: _____

8. CERTIFICATION

I certify that ALL of the project information contained in this receipt (including project location, project size/configuration, project type, answers to questions) is true, accurate and complete. In addition, if the project type, location, size or configuration changes, or if the answers to any questions that were asked during this online review change, I agree to re-do the online environmental review.

applicant/project proponent signature

date

610-356-9550
FAX 610-356-5032

Herbert E. MacCombie, Jr., P.E.

CONSULTING ENGINEERS & SURVEYORS, INC.
1000 PALMERS MILL ROAD
MEDIA, PA 19063

James W. MacCombie, P.E., P.L.S.
Herbert E. MacCombie, III, Technician

REPLY TO:
P.O. BOX 118
BROOMALL, PA 19008-0118

June 15, 2012

Gary Horne, New Business Representative
AQUA Pennsylvania, Inc.
762 W. Lancaster Avenue
Bryn Mawr, PA 19010

Re: Water Availability
Plan of Proposed Planned Apartment Development - Smith Tract
West Chester Pike
East Goshen Township, Chester County, PA

Dear Mr. Horne:

Please be advised that our client, Goshen Meadows L.P., has made application to East Goshen Township for Conditional Use Approval for a proposed planned apartment development. It is hereby respectfully requested that consideration be given to Aqua's ability and wiliness to provide domestic and fire service water for the proposed development.

The proposed development proposes 60 two-bedroom luxury apartments in five buildings and the adaptive reuse of the existing historic structure with four one-bedroom luxury apartments. The proposed development of 64 units will generate 200 GPD per unit for a total of 12,800 GPD. Please refer to the enclosed letter from PaDEP to Pennsylvania American Water Company, dated May 29, 2008 regarding the allocation of flow for planning purposes. All of the proposed sewage will ultimately enter the East Goshen Township sanitary sewer system. A copy of the Plan of Proposed Improvements is included for your use.

June 15, 2012
Water Availability
Proposed Planned Apartment Development - Smith Tract
Page 2

Please contact our office if you have any questions.

Very truly yours,

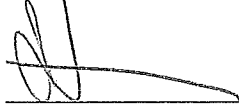
A handwritten signature in black ink, appearing to be "Dennis F. O'Neill", written over a horizontal line.

Dennis F. O'Neill, P.E.

Copy: Scott Fagan
Mark Thompson, Esq.
Mark A. Gordon, Director of Code Enforcement, Zoning Officer ✓

EAST GOSHEN MUNICIPAL AUTHORITY
EAST GOSHEN TOWNSHIP
1580 PAOLI PIKE, WEST CHESTER, PA 19380-6199

July 5, 2012

To: Municipal Authority
From: Mark Miller
Re: June Monthly Report

The Public Works Department started the closure of the Lockwood Plant on June 18th when we fabricated a floating dock for the pump. The actual earth moving began June 21st; we have hauled in approximately 12,000 yards at no cost to the Authority with the exception of the heavy equipment. He had to hire dump trucks to move the 3000 yards of dirt that we had stock piled in Milltown which took two days to move. We brought in 136 tons of lime to cover the sludge from the first pond. So far the job has gone very well and the neighbors have been very cooperative. We have stayed in contact with the Homeowners Association explaining what we are doing on a weekly basis; we have not received any complaints. Photos are attached.

Meters: Have been read with no problems to report.

C.C. Collection: Pumping Stations have been visited on a daily basis, bar screens were cleaned and the wet well was washed down. We were notified of three lateral backups, each was cleared with the use of the trap plunger.

R.C. Collection: No problems to report.

Ridley Creek Plant: The meter has been ordered that we had approved last month.

I met with Mike Ellis regarding the Muffin monster that was approved last month to discuss the installation. Rick and I have decided to install the unit in-house rather than bidding out. We will have Lenni Electric complete the electric and Public Works install the unit.

PA- One Calls: We responded to 131 PA One Calls for June.

We installed a dozen caps on the systems.

Put line on exposed
sludge -

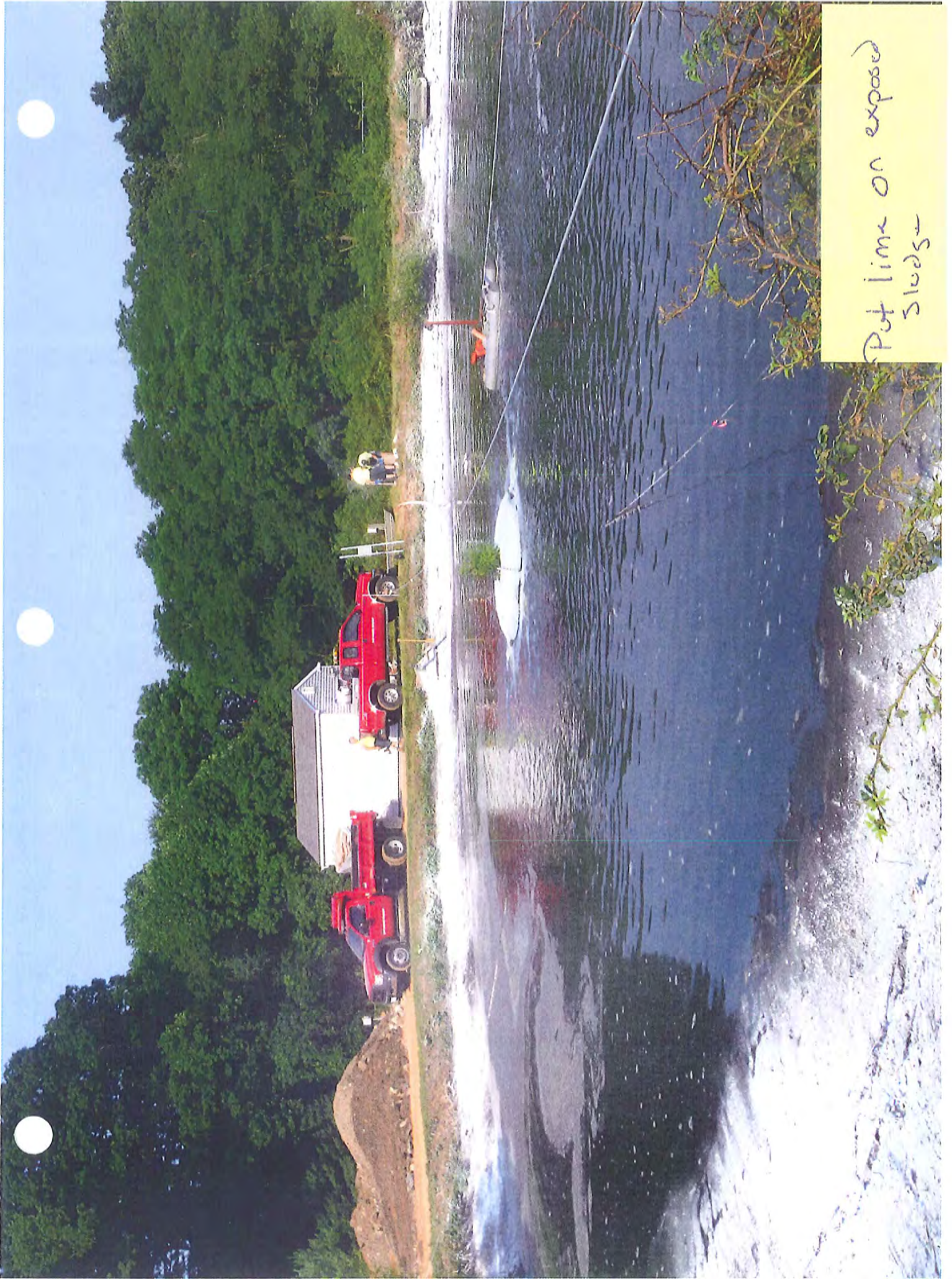

Before
Day 1



Day 1
Ready for Dirt Delivery



Setting up Pump
for Bypass Pumping



Mark - Mike setting up
Floating Pump





Setting up hose for
Bypass Pumping

Ready for Dirt
delivery



Backfilling



Crew Pushing dirt to
pond.



1st day of backfilling



There used to be
3000 yds of dirt.



Pond 1



Just about done
Pond 1





Pond 2



Dirt for Pond 2



MEMORANDUM

TO: East Goshen Municipal Authority Board
Rick Smith, Township Manager

FROM: Daniel Barbato, P.E.
Authority Engineer

DATE: July 5, 2012

SUBJECT: Engineer's Report

Invoices

- Invoices with summaries are provided under separate cover.

Ridley Creek Sewage Treatment Plant (RCSTP)

- No activity this period. We will assist with supporting and reviewing warranty claims and with plant troubleshooting as requested.

LCSTP Elimination

- All sewers and manholes have been tested and televised. Restoration has also been performed including grading, seeding, mulching, paving, and curb replacement.
- Remaining work includes abandoning existing sewers and manholes in-place with flowable fill, preparation of as-built plans, and minor punchlist work (such as one cast-iron box may still need to be installed over one cleanout). The flowable fill work is scheduled for Thursday, July 12.
- We have performed on-site, part-time construction inspection services throughout the duration of this work. We have also continued to provide in-office construction support as needed.
- We anticipate the contractor will submit Invoice #2 by Friday, July 6. We have already measured quantities for the invoice with the contractor.

Hershey's Mill PS Diversion and Reserve PS Elimination

- We submitted the Reserve PS and the Hershey's Mill PS GP-5 "General Permit for Utility Line Stream Crossing" applications to DEP on June 27 and June 22 respectively.
- We will make Erosion and Sedimentation Control submissions for both projects to the Chester County Conservation District by Friday, July 6.
- We are preparing a Closure Plan for the Reserve PS and a Part 2 WQM Permit Amendment for the Hershey's Mill PS, now that the details of construction (i.e. manhole

connections, pipe materials, sewer routing, etc.) have generally been agreed-upon, and we expect to submit both to DEP by the end of July.

Marydell PS Elimination

- We met with PECO on-site on June 26 to discuss overhead and underground utility locations and conflicts. If any part of a trench is within 4 feet of a utility pole, the pole must be braced by PECO. We are tentatively planning to revise the route of the new sewer to be directly under the edge of the Paoli Pike shoulder instead of on the shopping center side of the utility poles in order to avoid clearing 5+ trees and to minimize construction challenges associated with the overhead electric lines. However, there is an underground gas anode line that may be in the exact location of the revised sewer, although the sewer would be significantly deeper.
- We have also received additional information and utility plans from Verizon about their telecommunications ductbank that was marked-out just inside the Paoli Pike travel lane (just inside the white line). Verizon has informed us that the ductbank is not concrete encased. They have also informed us that they own the conduits, but AT&T runs lines through them.
- To determine with certainty if this revised location is feasible for the sewer, we have coordinated with the Township to perform three soft-dig exploratory test pits along the Paoli Pike shoulder. We prepared a PennDOT Highway Occupancy Permit (HOP) application for the test pits, and the permit was issued on July 3.
- We have also prepared a separate HOP application for the sewer construction, but it has not yet been submitted. Depending upon when the test pits are scheduled, we may submit the HOP application before performing the test pits to get PennDOT's review process underway. This application proposes a jack & bore (trenchless) installation across Boot Road and open-cut trenching for the remainder of the work. The Paoli Pike crossing at Saratoga Drive is proposed to occur at night with a full road closure and detour.
- We are preparing a Closure Plan for the Marydell PS that we expect to submit to DEP by the end of July, pending final determination of the sewer location.

Hershey's Mill PS Capacity Evaluation

- We previously performed drawdown testing at the pump station and an analysis of pump and system curves to verify the station has capacity to handle peak instantaneous flows following the Lockwood Chase diversion. One pump was found to have inadequate capacity. The Township quickly replaced the pump. We performed a follow-up drawdown test on June 11. During the test, the flow meter showed that the replaced pump was still not pumping at required capacity, but our follow-up calculations indicate that it likely does have adequate capacity.

Hershey's Mill Muffin Monster

- We expect to have a concept design completed by the end of July. We will then set up a meeting on-site with all applicable parties (Pennoni, Township and Public Works, the Township's controls contractor, and the Muffin Monster supplier) to review the concept

EGMA 1200

and determine who will perform the construction (Public Works or a contractor) and how the materials will be acquired (direct purchase by Authority or by contractor).

BIG FISH ENVIRONMENTAL SERVICES, INC.

June 2012 - Ridley Creek and Lochwood Sewage Treatment Plant Operations Report

Executive Summary

Treatment Process Operation

Sequencing batch reactors (SBRs) numbered 1, 3 and 4 were in service during the month of June. SBR No. 2 remains out of service with a proximately a mixture of 1 foot of sludge and rainwater within the tank. Efforts to clean the tank using a submersible pump rated with a TDH of 100 ft resulted in tripping the 20 amp circuit breaker. Replacement of the 20-amp circuit with a 30-amp circuit is in progress. Upon installation of the 30-amp circuit breaker, cleaning of SBR No. 2 will be scheduled to transfer the contents to sludge holding tank No. 2.

During the month of May, there were no exceedances of the permitted effluent limitations. On site analysis of split, samples with the certified contract laboratory are on going. Trend data indicates consistent patterns of the onsite analysis test results are generally greater than the contract laboratory, with the exception of total suspended solids. Steps to improve the precision of onsite analysis included rinsing all glassware used for phosphorus analysis with a 10% v/v solution of hydrochloric acid solution. Duplicate sample analysis is ongoing and purchase of a NIST standard (and associated glassware) is under investigation.

Adjustments to the SBR process during June include lowering the mixed liquor concentration (MLSS) to lower the food to mass ratio (F:M ratio) to eliminate the conditions of a long sludge age and low F:M ratio. Filamentous bacteria identified as *Microthrix parvicella* thrives under the conditions of long SRT and low F:M ratios. Adjusting the SBR control set points to adjust for the increased ambient temperatures (effluent temperatures around 23°C), increased settle times and management of extended anoxic/anaerobic conditions resultant of settle and idle times (100 to 120 minutes).

A summary of the flow data for May and June 2012 is presented for review.

Flow data:

May 2012		
Flow Meter Location	Total Volume for Month, MGD	Average Daily Flow, gpd
Influent Wastewater	10.664	344,001
Treated Effluent to Disc Filters	10.313	332,698
Final Effluent Discharge	4.833	155,903
Applebrook Golf Course	2.052	66,210

BIG FISH ENVIRONMENTAL SERVICES, INC.

June 2012 - Ridley Creek and Lochwood Sewage Treatment Plant Operations Report

June 2012		
Flow Meter Location	Total Volume for Month, MGD	Average Daily Flow, gpd
Influent Wastewater	9.652	321,730
Treated Effluent to Disc Filters	9.232	307,735
Final Effluent Discharge	4.248	141,600
Applebrook Golf Course	2.090	69,653

Chemical Usage: June 2012

Chemical	Daily Average	Total Monthly
Soda Ash	122 lbs./day	3,650 pounds
Magnesium Hydroxide	13 gpd	390 gallons
Alum	31 gpd	922 gallons

Solids Dewatering and Disposal

The centrifuge dewatering system was not operated during the month of June. During the month, sludge wasting and decanting of the sludge holding tanks was ongoing. The sludge holding tank sludge was monitored for pH and alkalinity on average twice per week and total solids once per week.

Sludge holding tank No. 1 began the month as 0.71 % total solids and ended the month at 0.99% total solids.

Sludge holding tank No. 2 began the month as 0.78 % total solids and ended the month at 0.87% total solids.

The present rate of sludge thickening suggests a target sludge concentration of 1.0 to 1.2% total solids is anticipated during July, therefore providing adequate conditions for operation of the centrifuge sludge dewatering system.

Maintenance, Repairs and Warranty

Outstanding: Centrifuge replacement parts – Worth & Co. to replace parts used for warranty repair

ACTION: BFESI will provide Worth & Company a letter requesting resolution of the matter on or before October 1, 2012.

Outstanding: JWC fine screen has a failed UPS – Worth & Co. informed

ACTION: Corrected. BFESI personnel installed the replacement UPS provided by Worth & Company.

Outstanding: JWC fine screen upstream transducer – replacement connection scheduled for installation

BIG FISH ENVIRONMENTAL SERVICES, INC.

June 2012 - Ridley Creek and Lochwood Sewage Treatment Plant Operations Report

ACTION: BFESI personnel installed the replacement connector provided by the Township

Outstanding: SBR and Centrifuge MCC panel hour meters – Worth & Co. informed

ACTION: Pennoni Associates/Township to provide Worth & Company a copy of the short circuit study completed by Clinger Corporation.

Outstanding: Leaking PVC valves for alum piping to SBRs

ACTION: Worth repaired valve. Issue resolved.

Outstanding: Sludge holding tank aeration piping paint is failing
Unresolved

Outstanding: SBR No. 4 Alum valve fails to open.

Unresolved

Scheduled Maintenance/Repairs

Installed a vent pipe for the centrifuge drain line as recommended by former Alfa Laval Service Manager

Installed piping and valve to flush out polymer and sludge fed piping to the centrifuge from the centrifuge pump discharge piping.

Replaced the oil and extended sight tubes for all five (5) SBR blowers.

Replaced the UV lamps and quartz sleeves for UV Bank No, 1 Module 1. Removed all UV modules, cleaned and washed. Cleaned UV channel and returned all equipment to service.



SUPPLEMENTAL REPORT
DAILY EFFLUENT MONITORING

3800-FM-WSPR0435 7/2009

Facility Name:
Municipality:
Watershed:
Laboratories:

Ridley Creek Sewage Treatment Plant
East Goshen Municipal Authority
3-G
ALS Environmental

County: Chester
Month: 5 (select number)
Permit No.: PA0050504
Renewal application due 180 days prior to expiration.
This permit will expire on: February 28, 2017

Year: 2012
Outfall: 002

Parameter	Flow	pH	Dissolved Oxygen	CBOD5	TSS	Fecal Coliform	NH3-N	Total Phosphorus
Stage	1	1	1	1	1	1	1	1
Week	MGD	S.U.	mg/L	mg/L	mg/L	mg/L	mg/L	CFU/100 ml
	0.0							
	0.0							
1	Sun 4/29/12	7.23	9.37					
	Mon 4/30/12	7.33	9.34					
	Tue 5/1/12	7.29	8.73					
	Wed 5/2/12	7.27	7.86					
	Thu 5/3/12	7.07	9.04	<	2	<	1.0	0.424
	Fri 5/4/12	7.04	8.96					
	Sat 5/5/12	7.15	8.15					
2	Sun 5/6/12	6.89	8.17					
	Mon 5/7/12	7.28	9.10					
	Tue 5/8/12	7.24	8.78					
	Wed 5/9/12	7.18	8.34					
	Thu 5/10/12	7.07	8.28	<	2	<	1.0	0.295
	Fri 5/11/12	7.06	8.41					
	Sat 5/12/12	7.34	8.40					
3	Sun 5/13/12	7.48	8.85					
	Mon 5/14/12	7.85	8.91					
	Tue 5/15/12	7.86	8.96					
	Wed 5/16/12	7.82	8.97					
	Thu 5/17/12	7.78	8.69	<	2	<	1.0	0.010
	Fri 5/18/12	7.75	8.78					0.87
	Sat 5/19/12	6.89	8.70					
4	Sun 5/20/12	6.88	9.60					
	Mon 5/21/12	6.84	9.07					
	Tue 5/22/12	6.79	8.82					
	Wed 5/23/12	6.81	8.72					
	Thu 5/24/12	7.10	8.15	<	2	<	1.0	0.136
	Fri 5/25/12	6.90	7.68					<
	Sat 5/26/12	7.01	8.40					
5	Sun 5/27/12	6.98	8.15					
	Mon 5/28/12	7.14	8.09					
	Tue 5/29/12	6.95	8.23					
	Wed 5/30/12	7.22	8.54					
	Thu 5/31/12	6.98	8.26	<	2	<	1.0	0.193
	Fri 6/1/12	7.08	8.39					0.11
	Sat 6/2/12	6.84	8.46					

Statistics for DMR

Daily Minimum (Conc.):	6.79		7.58		2		5		1		0.01		0.1
Daily Maximum (Conc.):	7.85		5.1		2		12		1		0.424		0.87
Max Avg Weekly (Conc.):			8.54		2		12		1		0.424		
Avg Monthly (Conc.):			8.54		2		7		1		0.211		0
Geometric Mean (Conc.):													
Max Avg Weekly (Load):	0.07		5		1		6		0.5		0.2		
Avg Monthly (Load):	0.066		5		1		4		0.5		0.1		
Total Monthly (Load):	2.05		146		32		118		16		3		
Daily Minimum (Load):	0.036												
Daily Maximum (Load):	0.096												

I certify under penalty of law that this document was prepared under my direction or supervision in accordance with a system designed to assure that qualified personnel gather and evaluate the information submitted. Based on my inquiry of the person or persons who manage the system or those persons directly responsible for gathering the information, the information submitted is, to the best of my knowledge and belief, true, accurate and complete. I am aware that there are significant penalties for submitting false information, including the possibility of fine and imprisonment for knowing violations. See 18 Pa.C.S. § 4904 (relating to unknown falsification).

Prepared By: Scott A. Towler
Title: Plant Operator

License No.: T0390
Date: 27-Jun-12

FINAL REPORT

Ridley Creek Sewage Treatment Plant Monthly Operations Report

Design Basis	Flow	BOD ₅		TSS		NH ₄ -N		TKN, mg/L		Phosphorus, Total, mg/L	
		mg/L	lbs/day	mg/L	lbs/day	mg/L	lbs/day	mg/L	lbs/day	mg/L	lbs/day
MGD Average		335	2,098	320	2,001	32	200	48	301	9.1	57
Sample date											
May 3, 2012	0.2891	151	364	391	943	8.48	20	15.2	37	3.1	7
May 10, 2012	0.3406	152	367	477	1,150	2.95	7	7.6	18	2.2	5
May 17, 2012	0.2821	283	528	506	1,220	27.8	67	48.7	117	8.4	20
May 24, 2012	0.2845	488	354	1257	3,031	26.5	64	34.5	83	3.7	9
May 31, 2012	0.2803	598	1,442	533	1,285	31.7	76	31	75	4.3	10
Average	0.2953	334	611	633	1526	19	47	27	66	4	10
Minimum	0.2803	151	354	391	943	3	7	8	18	2	5
Maximum	0.3406	598	1442	1257	3031	32	76	49	117	8	20

Final Effluent - Out Fall 001											
NPDES Permit Discharge Limitations	Flow	CBOD ₅		TSS		NH ₄ -N		Phosphorus, Total, mg/L		Fecal Coliform	
		mg/L	lbs/month	mg/L	lbs/month	mg/L	lbs/month	mg/L	lbs/month	Geo Mean	Geo Mean
	MGD Average	20	125	21	131	7	44	0.5	3	200	1,000
	Instantaneous Maximum	40		42							
Sample date											
May 3, 2012	0.1390	2.0	2	12	6	0.424	0.12	0.23	0.12	1	0.0000
May 10, 2012	0.1640	2.0	2	8	9	0.295	0.34	0.12	0.14	1	0.0000
May 17, 2012	0.1400	2.0	2	6	7	0.100	0.14	0.87	1.01	1	0.0000
May 24, 2012	0.1340	2.0	2	6	7	0.135	0.16	0.10	0.12	1	0.0000
May 31, 2012	0.1136	2.0	2	5	6	0.193	0.22	0.11	0.13	1	0.0000
Average	0.1381	2.0	2	7	7	0.229	0.19	0.29	0.30	1	0.0000
Minimum	0.1136	2.0	2	5	6	0.100	0.12	0.10	0.12	1	0.0000
Maximum	0.1640	2.0	2	12	9	0.424	0.34	0.87	1.01	1	0.0000

DRAFT REPORT

Ridley Creek Sewage Treatment Plant Monthly Operations Report

Design Basis	Flow	BOD ₅		TSS		NH ₄ -N		TKN, mg/L		Phosphorus, Total, mg/L	
		mg/L	lbs/day	mg/L	lbs/day	mg/L	lbs/day	mg/L	lbs/day	mg/L	lbs/day
MGD Average		335	2,098	320	2,001	32	200	48	301	9.1	57
Sample date											
June 7, 2012	0.2739	181	413	238	544	31.8	73	31.8	73	4.4	10
June 14, 2012	0.2643	178	407	406	927	34.3	78	41.1	94	4.2	10
June 21, 2012	0.2603										
June 28, 2012	0.2401										
Average	0.2597	180	410	322	736	33	75	36	83	4	10
Minimum	0.2401	178	407	238	544	32	73	32	73	4	10
Maximum	0.2739	181	413	406	927	34	78	41	94	4	10

Final Effluent - Out Fall 001											
NPDES Permit Discharge Limitations	Flow	CBOD ₅		TSS		NH ₄ -N		Phosphorus, Total, mg/L		Fecal Coliform	
		mg/L	lbs/month	mg/L	lbs/month	mg/L	lbs/month	mg/L	lbs/month	Geo Mean	Geo Mean
	MGD Average	20	125	21	131	7	44	0.5	3	200	1,000
	Instantaneous Maximum	40		42							
Sample date											
June 7, 2012	0.150	2.0	3	19	6	0.220	0.13	0.29	0.13	1	0.0000
June 14, 2012	0.132	2.0	3	6	8	0.100	0.13	0.22	0.28	1	0.0000
June 21, 2012	0.112										
June 28, 2012	0.110										
Average	0.1260	2.0	3	13	7	0.160	0.13	0.26	0.20	1	0.0000
Minimum	0.1100	2.0	3	6	6	0.100	0.13	0.22	0.13	1	0.0000
Maximum	0.1500	2.0	3	19	8	0.220	0.13	0.29	0.28	1	0.0000

**SUPPLEMENTAL REPORT
DAILY EFFLUENT MONITORING**

3800-PM-WSPR0435 7/2009

Facility Name: Ridley Creek Sewage Treatment Plant
Municipality: East Goshen Municipal Authority County: Chester
Watershed: 3-G
Laboratories: ALS Environmental

Month: 5 (select number) Year: 2012
Permit No.: PA0050504 Outfall: 001
Renewal application due 180 days prior to expiration.
This permit will expire on: February 28, 2017

Parameter	Flow	pH	Dissolved Oxygen	CBOD5	BOD5	TSS	TSS	Fecal Coliform	NH3-N	Total Phosphorus
Stage	1	1	1	1	RI	1	RI	1	1	1
Unit	MGD	S.U.	mg/L	mg/L	mg/L	mg/L	mg/L	CFU/100 ml	mg/L	mg/L
Week	Day	Date								
1	Sun	4/29/12	0.164	7.23	9.37					
	Mon	4/30/12	0.172	7.33	9.34					
	Tue	5/1/12	0.019	7.29	8.73					
	Wed	5/2/12	0.127	7.27	7.86					
	Thu	5/3/12	0.139	7.07	9.04	2				
	Fri	5/4/12	0.199	7.04	8.96	151	12			0.424
	Sat	5/5/12	0.165	7.15	8.15					
2	Sun	5/6/12	0.158	6.89	8.17					
	Mon	5/7/12	0.203	7.28	9.10					
	Tue	5/8/12	0.157	7.24	8.78					
	Wed	5/9/12	0.157	7.18	8.34					
	Thu	5/10/12	0.164	7.07	8.28	2				
	Fri	5/11/12	0.095	7.06	8.41	152	8			0.295
	Sat	5/12/12	0.153	7.34	8.40					
3	Sun	5/13/12	0.213	7.46	8.85					
	Mon	5/14/12	0.175	7.85	8.91					
	Tue	5/15/12	0.194	7.86	8.96					
	Wed	5/16/12	0.165	7.82	8.97					
	Thu	5/17/12	0.140	7.78	8.69	263	6			0.87
	Fri	5/18/12	0.219	7.75	8.78					
	Sat	5/19/12	0.139	6.89	8.70					
4	Sun	5/20/12	0.185	6.88	8.60					
	Mon	5/21/12	0.138	6.84	9.07					
	Tue	5/22/12	0.198	6.79	8.82					
	Wed	5/23/12	0.144	6.81	8.72					
	Thu	5/24/12	0.134	7.10	8.15	528	6			0.135
	Fri	5/25/12	0.162	6.90	7.68					
	Sat	5/26/12	0.117	7.01	8.40					
5	Sun	5/27/12	0.136	6.98	8.15					
	Mon	5/28/12	0.255	7.14	8.09					
	Tue	5/29/12	0.091	6.95	8.23					
	Wed	5/30/12	0.156	7.22	8.54	354	5			0.193
	Thu	5/31/12	0.136	6.98	8.26					
	Fri	6/1/12	0.179	7.08	8.39					
	Sat	6/2/12	0.163	6.84	8.46					
Statistics for QWR										
Daily Minimum (Conc.):		6.79		7.58	<	2		151	<	5
Daily Maximum (Conc.):		7.86		9.1	<	2		528	<	12
Max Avg Weekly (Conc.):				8.84	<	2		528	<	12
Avg Monthly (Conc.):				8.54	<	2		294	<	7
Geometric Mean (Conc.):										
Max Avg Weekly (Load):										
Avg Monthly (Load):										
Total Monthly (Load):										
Daily Minimum (Load):										
Daily Maximum (Load):										

I certify under penalty of law that this document was prepared under my direction or supervision in accordance with a system designed to assure that qualified personnel gather and evaluate the information submitted. Based on my inquiry of the person or persons who manage the system or those persons directly responsible for gathering the information, the information submitted is, to the best of my knowledge and belief, true, accurate and complete. I am aware that there are significant penalties for submitting false information, including the possibility of fine and imprisonment for knowing violations. See 18 Pa.C.S. § 4924 (relating to unsworn testimony).

Prepared By: Scott A. Towler
Title: Plant Operator

License No.: T0390
Date: 27-Jun-12

2011 FLOWMETERS

2012 JUNE 2ND QUARTER- METERS FROM WEST GOSHEN - CC COLLECTION

Precip	WESTTOWN WAY			ELLIS LANE			PAOLI PIKE			WILSON DRIVE			SUMMIT		NET	
			1000			10			10			10	GPD	FLOWS	DATE	
Inches	DATE	READING	GPD	READING	GPD	READING	GPD	READING	GPD	READING	GPD	GPD				
1.30	06/01/12											20,400	0		06/01/12	
0.00	06/02/12											20,400	0		06/02/12	
0.08	06/03/12											20,400	0		06/03/12	
0.17	06/04/12	2,556,068	1,484,333	24,962,075	142,577	12,404,919	88,167	13,994,531	80,620	20,400	1,172,970	20,400	0		06/04/12	
0.00	06/05/12	2,557,282	1,214,000	24,978,228	161,530	12,410,556	56,370	13,999,398	48,670	20,400	947,430	20,400	0		06/05/12	
0.00	06/06/12											20,400	0		06/06/12	
0.03	06/07/12	2,559,376	1,047,000	24,993,121	74,465	12,423,502	64,730	14,015,970	82,860	20,400	824,945	20,400	0		06/07/12	
0.00	06/08/12	2,560,461	1,085,000	25,003,127	100,060	12,429,545	60,430	14,022,811	68,410	20,400	856,100	20,400	0		06/08/12	
0.00	06/09/12											20,400	0		06/09/12	
0.00	06/10/12											20,400	0		06/10/12	
0.00	06/11/12	2,563,694	1,077,667	25,032,729	98,673	12,447,986	61,470	14,049,405	88,647	20,400	828,877	20,400	0		06/11/12	
1.10	06/12/12											20,400	0		06/12/12	
0.00	06/13/12											20,400	0		06/13/12	
0.00	06/14/12											20,400	0		06/14/12	
0.00	06/15/12	2,568,405	1,177,750	25,077,415	111,715	12,472,214	60,570	14,097,626	120,563	20,400	884,913	20,400	0		06/15/12	
0.00	06/16/12											20,400	0		06/16/12	
0.00	06/17/12											20,400	0		06/17/12	
0.00	06/18/12	2,571,550	1,048,333	25,106,082	95,557	12,489,699	58,283	14,126,922	97,653	20,400	796,840	20,400	0		06/18/12	
0.00	06/19/12	2,572,648	1,098,000	25,115,626	95,440	12,495,689	59,900	14,138,738	118,160	20,400	824,500	20,400	0		06/19/12	
0.00	06/20/12	2,573,732	1,084,000	25,125,060	94,340	12,501,775	60,860	14,150,573	118,350	20,400	810,450	20,400	0		06/20/12	
0.00	06/21/12											20,400	0		06/21/12	
0.32	06/22/12											20,400	0		06/22/12	
0.00	06/23/12											20,400	0		06/23/12	
0.00	06/24/12											20,400	0		06/24/12	
0.00	06/25/12											20,400	0		06/25/12	
0.00	06/26/12											20,400	0		06/26/12	
0.00	06/27/12											20,400	0		06/27/12	
0.00	06/28/12	2,582,193	1,057,625	25,200,228	93,960	12,547,515	57,175	14,235,899	106,658	20,400	799,833	20,400	0		06/28/12	
0.00	06/29/12	2,583,197	1,004,000	25,209,230	90,020	12,553,151	56,360	14,242,468	65,690	20,400	791,930	20,400	0		06/29/12	
0.00	06/30/12											20,400	0		06/30/12	
3.99			1,125,246		105,303		62,210		90,570	20,400	867,162					
				</												

2011 FLOWMETERS

2012 JUNE 2ND QUARTER- METERS FROM WEST GOSHEN - CC COLLECTION

[illegible]

2012 SUMMARY OF METER READINGS

	WESTTOWN WAY	ELLIS LANE	PAOLI PIKE	WILSON DRIVE	SUMMIT	HERSHEY MILL	ASHBRIDGE	HICKS	RESERVOIR	SHERMAN	BARKWAY
JANUARY	1,296,433	152,585	69,729	69,440	20,400	73,086	90,225	67,846	909,322	6,922	12,327
FEBRUARY	1,172,663	140,579	61,074	65,911	20,400	63,555	73,939	295,466	1,019,637	6,561	11,350
MARCH	1,157,405	222,657	61,103	71,039	20,400	60,276	70,943	300,484	0	6,707	8,575
APRIL	1,059,167	186,208	53,353	57,578	20,400	58,987	63,358	285,508	285,613	6,407	10,305
MAY	1,144,546	167,830	63,648	81,622	20,400	55,378	60,690	304,075	652,083	6,354	10,862
JUNE	1,125,246	105,303	62,210	90,570	20,400	70,259	61,597			6,517	10,177
JULY											
AUGUST											
SEPTEMBER											
OCTOBER											
NOVEMBER											
DECEMBER											
Total Flows											
Monthly Ave	1,159,243	162,527	61,853	72,693	20,400	63,590	70,125	250,676	573,331	6,578	10,599

To
West Goshen 862,170

2012 SUMMARY OF METER READINGS

WESTTOWN WAY	ELLIS LANE	PAOLI PIKE	WILSON DRIVE	SUMMIT
-----------------	---------------	---------------	-----------------	--------

JANUARY	1,296,433	152,585	69,729	69,440	20,400
FEBRUARY	1,172,663	140,579	61,074	65,911	20,400
MARCH	1,157,405	222,657	61,103	71,039	20,400
APRIL	1,069,776	186,208	53,353	57,578	20,400
MAY	1,144,546	167,830	63,648	81,622	20,400
JUNE	1,125,246	105,303	62,210	90,570	20,400
JULY					
AUGUST					
SEPTEMBER					
OCTOBER					
NOVEMBER					
DECEMBER					

Total Flows					
-------------	--	--	--	--	--

Monthly Ave	1,161,012	162,527	61,853	72,693	20,400
-------------	-----------	---------	--------	--------	--------

Flowmeters June 2012

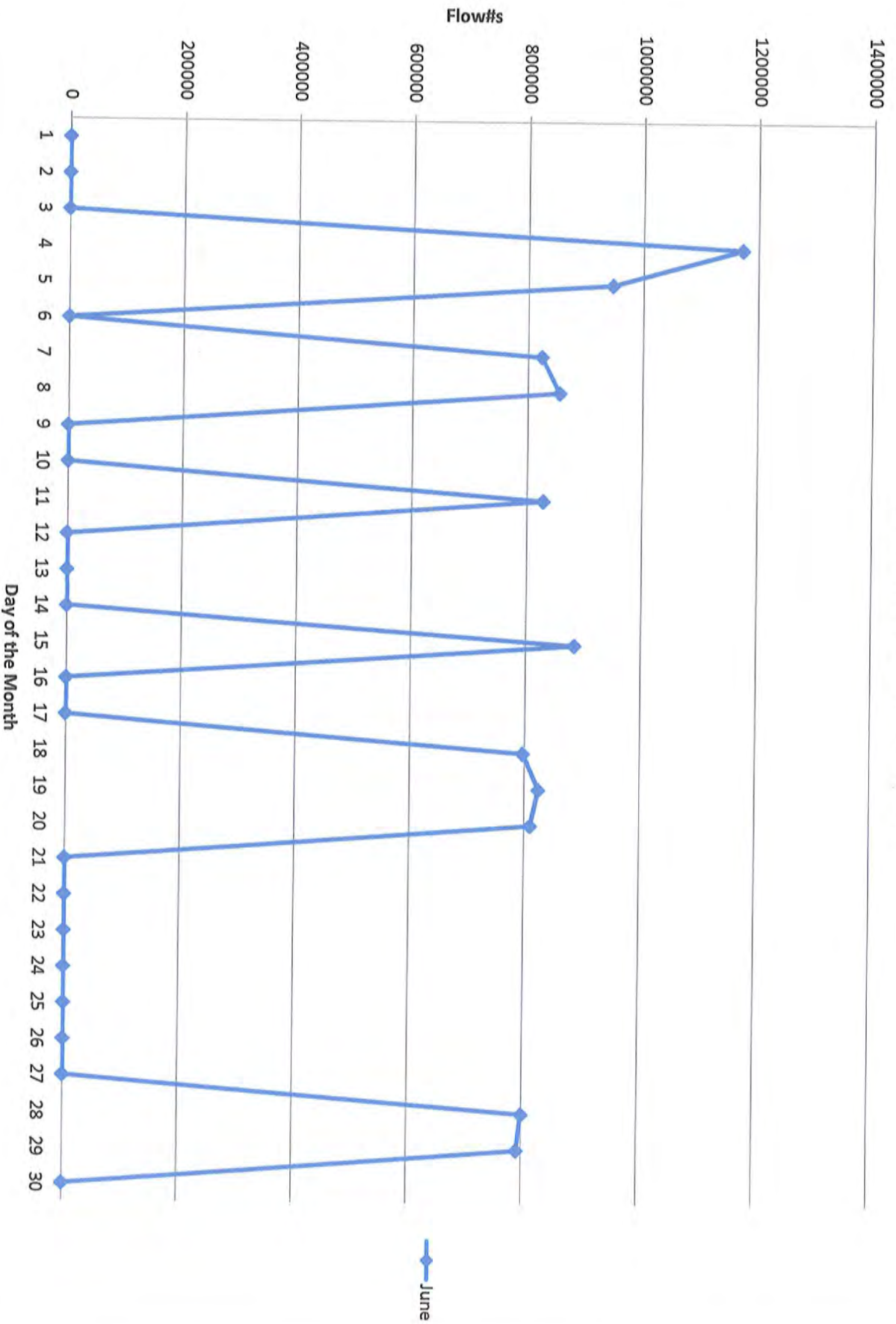

Monthly Totals 2012 Jan-Dec

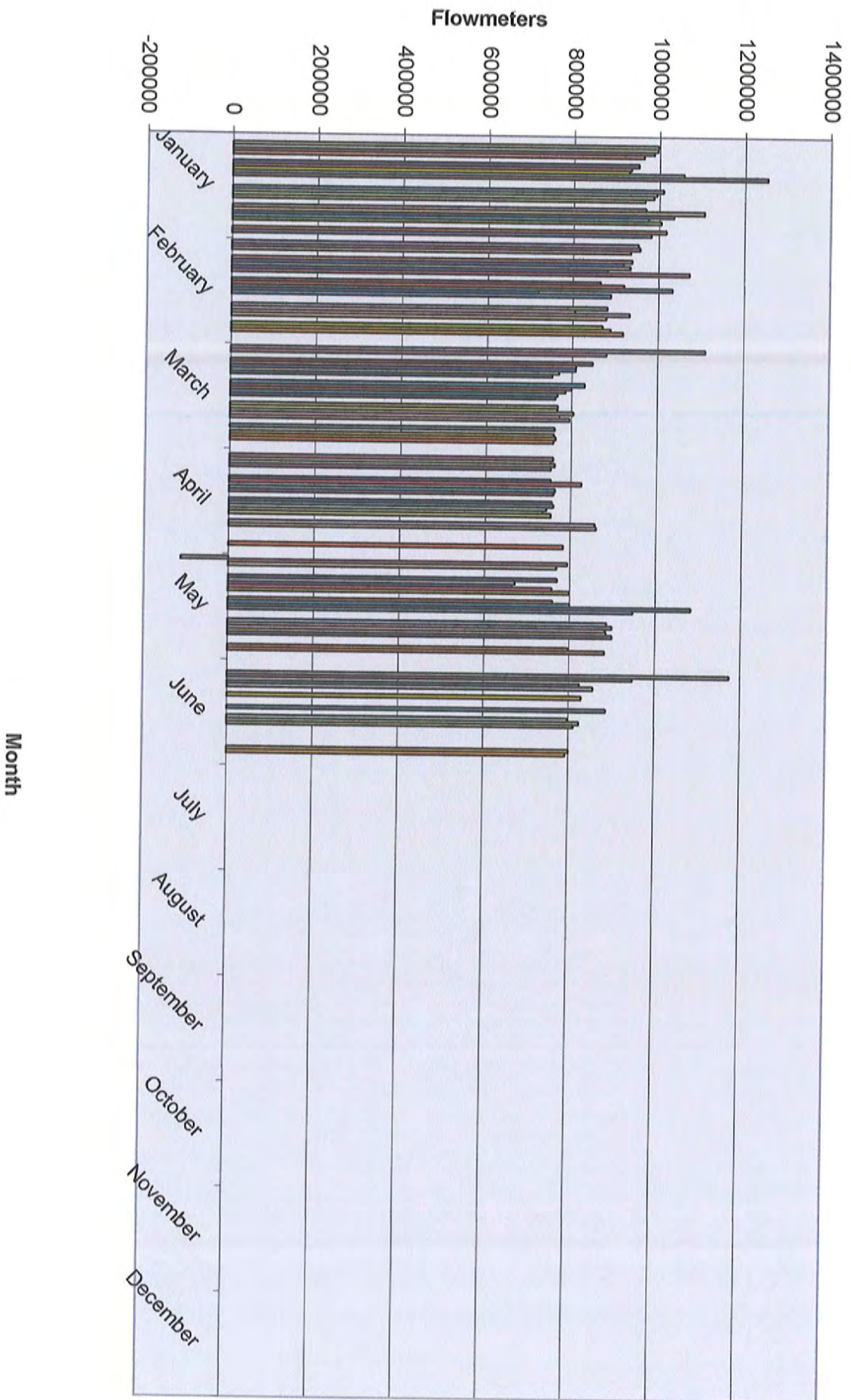

June Precip. 3.99 - 2012

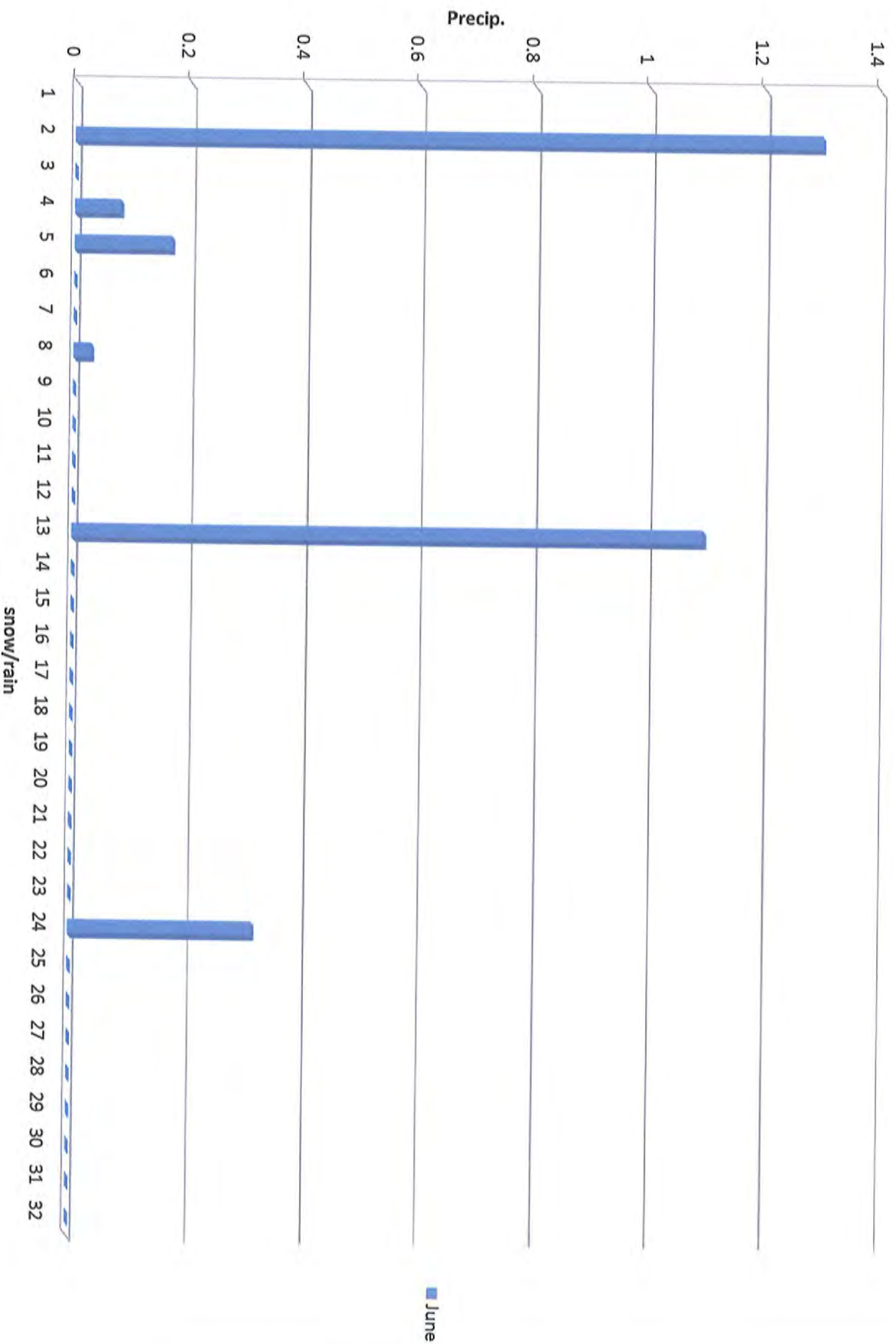

2012 Monthly Precipitation

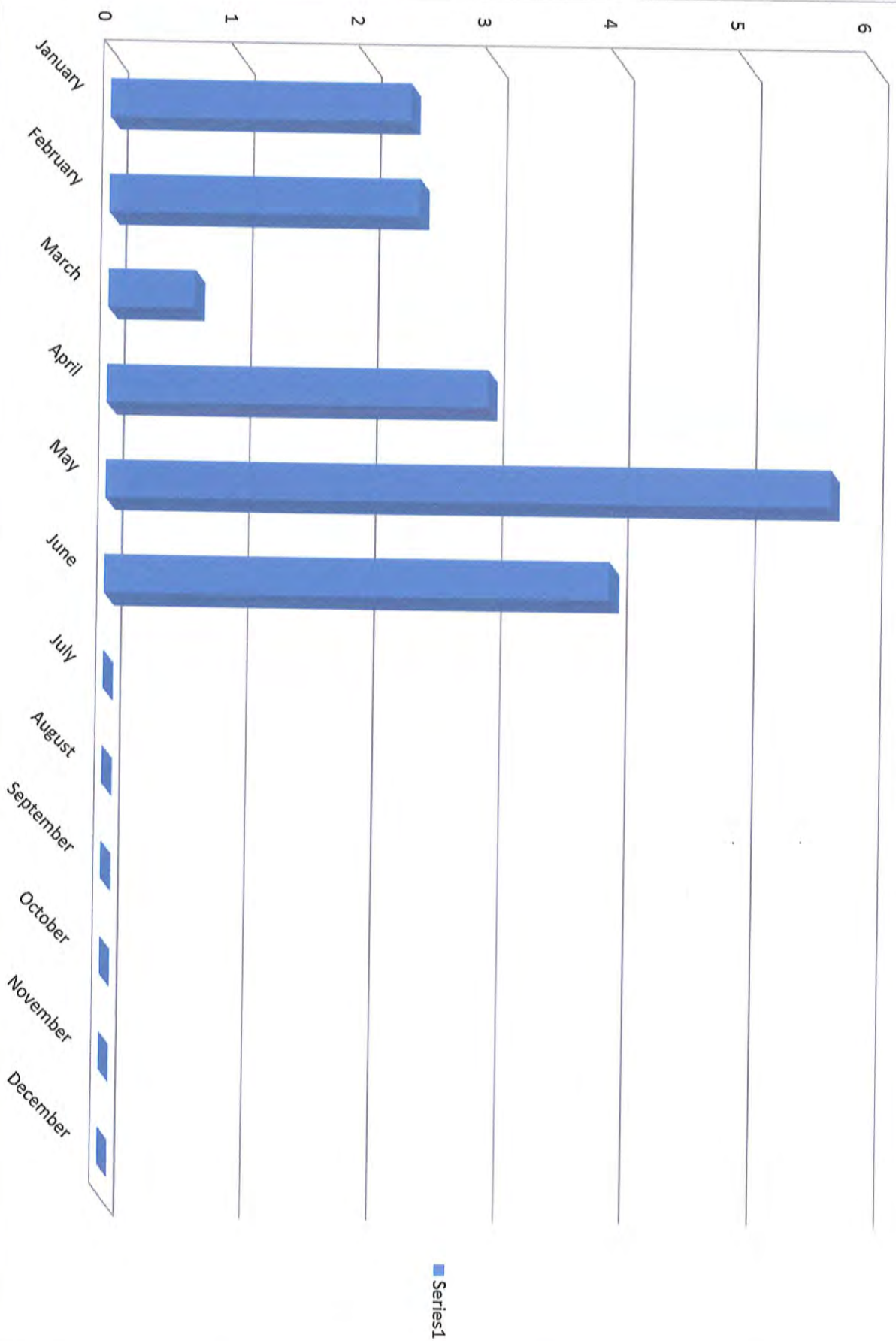



PENNSYLVANIA MUNICIPAL AUTHORITIES ASSOCIATION

1000 North Front Street, Suite 401 Wormleysburg, PA 17043

717-737-7655 * 717-737-8431(Fax)

www.municipalauthorities.org • info@municipalauthorities.org

FYI

TO: PMAA Region One Authorities

FROM: Douglas E. Bilheimer
Executive Director

DATE: June 15, 2012

Enclosed please find the official ballot, which indicates the names of the candidates, which have been nominated in your Region to assume the position of PMAA Director and Assistant Director for the next three-year period.

Your Authority, as an active PMAA Member, should vote for the candidates of your choice by marking the ballot in the appropriate block, have it certified by the Authority Secretary, and **return the ballot in the envelope provided to the Wormleysburg office no later than Friday, August 17, 2012.**

Please note that it is extremely important that the ballot be properly checked, certified by the Secretary, and returned to the Wormleysburg office. The special ballot envelope is enclosed.

BALLOT INSTRUCTIONS:

- 1) Place an X in the block opposite to the nominees for whom your Authority casts its vote.
- 2) Vote for only two candidates.

DEB/kaw
Enclosures

PMAA REGION ONE BALLOT

_____ **Director:** Raymond J. Berry, North Wales Water Authority

_____ **Assistant Director:** Michael Sullivan, Warwick Township Water & Sewer Authority

Name of Authority

Name

Title

BY _____

VOTE FOR TWO CANDIDATES

Place an X in the space opposite the nominee for whom you cast your ballot. A vote for more than two candidates voids the ballot.



FYI

RECEIVED
BY: _____

JUNE 11 2012

June 2012

Dear PLGIT Investor,

In March we alerted you to a change in PLGIT's operations in which PLGIT would begin to pass through costs for certain services. These charges are now effective, as of June 1, 2012 and are described in detail in PLGIT's Information Statement. We would like to take a moment to review the details of the charges and the reasons for them.

Importantly, for each of the services on which a fee will be assessed, there is generally a less costly alternative. We would be happy to help you determine if these alternatives would be appropriate for your specific needs.

What follows is an excerpt from our March letter about these costs:

Throughout its 30-year history, PLGIT has taken pride in the ability to provide services to investors with no out-of-pocket costs. However, due to the current low interest rate environment and in an attempt to control operating costs, it is necessary to inform you of fees that may be charged for certain services offered through PLGIT. These changes are being introduced as a way to reduce PLGIT operating costs and to potentially increase the net yield for investors on funds invested in PLGIT. Please be aware that the vast majority of PLGIT investors will continue to receive services with no out-of-pocket costs; however, investors that use high levels of certain services may incur a charge.

Right now, the country is facing a prolonged period of extremely low short-term interest rates. Near-zero yields on the types of investments that can be used in PLGIT portfolios, as well as the stated intention of the Federal Reserve to maintain low interest rates through 2014, have made it necessary for the PLGIT Board (the Board) to find ways to reduce the cost of operating PLGIT. The Board has asked all PLGIT service providers and sponsors to reduce contracted expenses.

Even after implementing these extensive cost-reduction measures, the Board decided it was necessary to charge for certain PLGIT services. When making its decisions about these charges, the Board had a number of objectives:

- When a fee is imposed, the Board tried to ensure whenever possible that there was an alternative action an investor could take to avoid the fee.
- Services will continue to be provided to a large segment of PLGIT investors at no out-of-pocket costs; any charges will affect those who have high levels of usage for a service.

*This information does not represent an offer to sell or a solicitation of an offer to buy or sell any fund or other security. Investors should consider the investment objectives, risks, charges and expenses before investing in any of the Trust's portfolios. This and other information about the Trust's portfolios is available in each portfolio's current Information Statement, which should be read carefully before investing. Copies of these Information Statements may be obtained by calling 1-800-572-1472 or are available on the Trust's website at www.plgit.com. While the PLGIT and PLGIT/ARM portfolios seek to maintain a stable net asset value of \$1.00 per share and the PLGIT/TERM portfolio seeks to achieve a net asset value of \$1.00 per share at its stated maturity, it is possible to lose money investing in the Trust. An investment in the Trust is not insured or guaranteed by the Federal Deposit Insurance Corporation or any other government agency. Shares of the Trust's portfolios are distributed by **PFM Fund Distributors, Inc.**, member Financial Industry Regulatory Authority (FINRA) (www.finra.org) and Securities Investor Protection Corporation (SIPC) (www.sipc.org). PFM Fund Distributors, Inc. is a wholly owned subsidiary of PFM Asset Management LLC.*

A description of the PLGIT CD Purchase Program is contained in the PLGIT Information Statement. The Information Statement contains important information and should be read carefully before investing. Investors may purchase Certificates of Deposit through the PLGIT CD Purchase Program only by executing an investment advisory agreement with the Program's Investment Adviser, PFM Asset Management LLC.

*SM **PLGIT, PLGIT-Class Shares, PLGIT/PLUS-Class Shares, PLGIT/I-Class Shares, PLGIT/TERM, PLGIT-CD, PLGIT/ARM, PLGIT/SAM, and PLGIT-CAP** are service marks of the Pennsylvania Local Government Investment Trust.*



Wastewater Treatment Plant

JOHN M. SCOTT
Plant Manager

848 S. Concord Rd.
West Chester, PA 19382
610-696-0900
Fax: 610-429-9360

FYI

June 27, 2012

East Goshen Township
Attn: Mr. Mark A. Gordon
1580 Paoli Pike
West Chester, PA 19380-6199

RE: Sanitary Sewage Capacity Verification
Proposed Residential Apartment Complex
1325 West Chester Pike

Dear Mr. Gordon:

This letter shall serve to verify that there is sufficient capacity in the West Goshen Sewer Authority collection, conveyance, and treatment system at the current time to accept flows from the proposed above referenced project. That anticipated additional sewage flow of 12,800 gallons per day (gpd) from this project will not create a hydraulic, organic, or 5-year projected overload.

East Goshen still has sufficient sewer capacity allocation available for this proposed apartment complex as well.

Please do not hesitate to call if you are in need of anything further.

Sincerely,



John M. Scott
Plant Manager

cc: file